



Advisory Board
Meeting

November 17, 2021

Agenda



Advisory Board Meeting

November 17, 2021

Web-Ex Information

Pursuant to City Code 2.14.060(A) and Utah Code section 52-4-207(2), the Airport Advisory Board adopted a rule permitting electronic meetings for this Board, regardless of whether a quorum is present at an anchor location, so long as such meetings comply with the Open and Public Meetings Act.

To access the meeting electronically, please visit:

<https://saltlakecity.webex.com/saltlakecity/onstage/g.php?MTID=eeae43f74f59e7d959fd9cffe77278433>



ADVISORY BOARD MEETING AGENDA

17 November 2021

8:00 A.M.

CONSENT

- A. Minutes of the 20 October 2021 Meeting

DISCUSSION

- A. Director's Report – Bill Wyatt, Executive Director, SLCDCA
- B. Airport Redevelopment Program (ARP) Update – Mike Williams, ARP Director, SLCDCA
- C. Preliminary Budget Briefing – Brian Butler, Finance Director, SLCDCA
- D. Concessions Program Update – Shane Andreasen, Director of Administration and Commercial Services, SLCDCA
- E. Nominations for Chair and Vice Chair – Steve Price, Board Chair

INFORMATION ITEMS

Financial Report – September 2021
Air Traffic Statistics – September 2021
Construction Report – November 2021

MEDIA CLIPPINGS

Media Clippings – November 2021

The next meeting will be held on **Wednesday, January 19, 2022**, at 8:00 a.m. Meetings are usually held in the Board Room, located on the third level of the airport terminal and via Web-ex unless otherwise posted. People with disabilities may make requests for reasonable accommodations no later than 48 hours in advance in order to attend this Airport Advisory Board Meeting. Accommodations may include alternate formats, interpreters, and other auxiliary aids. This is an accessible facility. For questions or additional information, please contact Tina Nee at 801-575-2042.



Advisory Board
Meeting

November 17, 2021

Minutes

SALT LAKE CITY DEPARTMENT OF AIRPORTS MINUTES OF ADVISORY BOARD MEETING

October 20, 2021

Members Present: Larry Pinnock
Steve Price, Chair
Theresa Foxley*
Cyndy Miller*
Arlyn Bradshaw*
Karen Mayne*
Roger Boyer*
Tye Hoffmann*

City Council Office: Sam Owen*

Mayor's Office: Rachel Otto*

Department of Airports: Bill Wyatt, Executive Director
Tina Nee, Administration
Brian Butler, Chief Financial Officer
Shaun Anderson, Contoller
Medardo Gomez, ORAT Director
Eddie Clayson, Director of Maintenance
Shane Andreasen, Director of Admin and Commercial Services
Brady Frederickson, Director of Planning and Environmental
Nancy Volmer, Director of Communication and Marketing
Ed Cherry, Director of IT*
Pete Higgins, Chief Operations Officer
Mike Williams, ARP Program Director
Captain Stefhan Bennett, SLPD*
Battalion Chief Rick Stratton, SLCFD*

Other: Kory Cox, HDR, Inc.
Paul Skeen, Eide Bailly
David Chipman*
Andy C*
Andrew Scanlon, Kimley-Horn*
Jim Lohse, FFKR Architects*

Steve Price called the meeting, held in-person at the SLCDA Admin Offices Board Room and via Web-Ex to order at 8:03 a.m. (* indicates the party attended virtually)

AGENDA

A. Minutes

A motion was made by Larry Pinnock and seconded by Cyndy Miller to approve the minutes of June 15, 2021 and September 15, 2021 as presented. All votes were affirmative; motion passed.

B. Director's Report

Bill Wyatt, Executive Director, updated the Airport Advisory Board regarding current events.

Bill Wyatt provided a brief update on passenger volumes and mobility, financial position, air service development, and construction.

Roger Boyer shared he has heard from two important people in the City the bussing to the long-term parking took way too long.

Bill Wyatt explained how the airport is short shuttle bus drivers.

Cyndy Miller added there has been a huge increase in leisure travel which affects parking.

Karen Mayne shared two Volunteer Ambassadors reach out to her saying the signage to ground transportation is not clear and there needs to be a taxi stand.

Bill Wyatt indicated a RFP for taxi service will be going out soon. In response to signage, the airport has just completed an analysis by a well-known firm. Updates will be happening.

C. Airport Redevelopment Program (ARP) Update – Mike Williams, ARP Director, SLCDA

Mike Williams, Airport Redevelopment Program (ARP) Director, presented an update on the ARP (presentation on file). Main points included were:

- Project statistics
- Safety and Schedule Stats, and Cost Summary
- Project statistics
- CGMP #5 – Terminal/South Concourse West/Gateway status
- CGMP #6 – Roadways/Parking Garage/Central Utility Plant status
- CGMP #7 – Baggage Handling System status
- CGMP #9A – SCW Apron Paving and Hydrant Fueling status
- CGMP #16 – NCP Phase 1
- CGMP #17 – NCP Baggage Handling System Phases 1 & 2 status
- CGMP #18 – NCP Apron Paving/ Hydrant Fueling
- Tracking Budget
- Job progress photos

Steve Price asked if the project has seen any repricing due to the fluctuations in the market.

Mike Williams answered that while they haven't seen any repricing, they have seen some delays (with studs, i.e.)

D. Presentation of Financial Audit Results – Paul Skeen, Eide Bailly and Brian Butler, Finance Director, SLCA

Paul Skeen, Edie Bailly and Brian Butler, Airport Finance Director, presented the results of the FY2021 audited financial statements (presentation on file.) Main points included were:

- FY 2021 Financial & Operational Highlights
- Enplaned Passenger Traffic
- Cost Per Enplaned Passenger (CPE) FY 2020
- CPE Ten Year History
- Budget Comparison
- Dash Cash on Hand
- Airline use Agreement Rates and Charges
- Comparison of Actual Airline Revenue
- Airline Revenues Represent a Modest by Increasing Share of Total Operating Revenues
- Comparison of Actual Non-Airline Revenue
- None-Airline Revenues Have Decreased 17.6% Since FY 2017
- Revenue Growth Has Outpaced Growth in Expenses and Enplanements
- Comparison of Actual Operating Expense

Cyndy Miller asked if CAREs funding is included in the DASH Cash figure.

Brian Butler indicated that no it isn't since a reimbursable grant. The Line of Credit is also not included.

Larry Pinnock inquired to the over-all cost savings.

Brian Butler explained it was due to staffing down.

Larry Pinnock also asked if landing fees were based on weight or frequency.

Brian Butler answered landing fees are based on weight.

E. Motion to Approve Audited Financials

Upon a motion by Cyndy Miller and seconded by Arlyn Bradshaw, the board approved the audited financials.

F. Master Plans Update – Brady Fredrickson, Director of Planning and Environmental, SLCDA

Brady Fredrickson, Airport Director of Planning and Environmental, presented an update to the Master Plans. (presentation on file.) Main points included were:

- Master Plan Process
- Forecasted Activity Levels

- Future Facility Requirements
- Preferred Alternatives
- Close Runway 14-32
- Runway Extension Alternatives
- Increasing Aircraft Capacity
- Airfield Enhancements
- Implementation Plan
- Looking Forward
- South Valley and Tooele Valley Master Plans

Steve Price asked about the completion of the central tunnel past concourse B and the start of concourse C.

Brady Fredrickson explained Phase 4 includes the central tunnel expansion to E and F taxiways and sets the airport up for concourse C expansion.

Larry Pinnock asked which Passenger Activity Level would trigger the need for concourse C.

Brady Fredrickson indicated it would be just beyond PAL 3.

Steve Price adjourned the meeting at 9:40 a.m.

J. Steven Price, Chair

Date

Erin Mendenhall, Mayor

Date



Advisory Board
Meeting

November 17, 2021

Discussion Items

AGENDA: DISCUSSION ITEM (A)
DATE: 17 November 2021
TO: Airport Advisory Board
FROM: Bill Wyatt, Executive Director
SUBJECT: **Executive Director's Report**

Bill Wyatt will present a monthly informational report to the Board, which may include:

1. ARP progress
2. Ground transportation update
3. Concessions and rental cars
4. Airport safety and security
5. Airport facilities and operations
6. General aviation
7. Passenger and airport users
8. Environmental matters
9. Financial condition
10. Legislative issues
11. Airlines
12. Communications and marketing

AGENDA: DISCUSSION ITEM (B)
DATE: 17 November 2021
TO: Airport Advisory Board
FROM: Bill Wyatt, Executive Director
SUBJECT: **Airport Redevelopment Program Update**

Mike Williams, Airport Redevelopment Program (ARP) Director, will present an update on the SLC Airport Redevelopment Program (presentation on file).



AIRPORT REDEVELOPMENT PROGRAM

Status Update 11/17/2021



Safety and Schedule



Safety Statistics

Numbers for the Current Month

- **OSHA National Average**
 - **Lost Time Rate 1.80 Recordable Rate 3.10**
- **HDJV Metrics**
 - **8,881,503 Total Trade Hours worked**
 - **Lost Time Rate 0.24 Recordable Rate 2.27**

Numbers for the Program Overall

- **ARP Metrics (HDJV+AOJV)**
 - **11,042,537 Total Trade Hours worked**

Schedule Status - Critical Path

- **Completion of Concourse 'A' East Steel Erection and Metal Decking Installation**
- **Completion of Concourse 'A' East Elevated Deck Concrete Placement**
- **Start of Roofing and Curtainwall Installation**
- **Overall Program is on schedule**

Near Term Schedule Milestones



Target Date	Current Date	Description
11/10/21	11/10/21	Central Tunnel Lid Pour Area D4
11/15/21	11/15/21	Concourse A East Mechanical Rooms Ready for Equipment
11/15/21	11/15/21	Concourse A East Start Curtainwall
11/15/21	11/15/21	Concourse A East Start Roofing
11/19/21	11/19/21	Concourse A East Pour Area D Level 2 Deck
11/19/21	11/19/21	Taxilane East Complete 12" Water Line Installation
11/29/21	11/29/21	Central Tunnel Area G (Conc B Basement) Bottom Slab Waterproofing
11/29/21	11/29/21	Concourse A East Start Area A Terrazzo Floor Preparation
12/02/21	12/02/21	Phase 3 All Building Trades Recommendations to Award Complete
12/16/21	12/16/21	Phase 3 CGMP 19A Submitted to FOC/CC for Consideration

Airport Redevelopment Program Overall Budget



Construction Budget October 2021	Budget 11/04/21 FOC	Committed Sep-21	Commitments Oct-21	*Pending Commitments	Revised Commitments	Earned to Date	Estimate at Completion
Closed TRP CGMPs 1, 2, 2A-2D, 3, 4, 9, 09A, 12	\$394,334,804	\$400,284,798	\$0	(\$5,949,994)	\$394,334,804	\$393,627,123	\$394,334,804
Closed NCP CGMPs 13, 14, 15, 16, 17, 18 & 19	\$487,882,444	\$487,852,444	\$0	\$0	\$487,852,444	\$487,852,444	\$487,882,444
CGMP 2E,F&H CMAR General Conditions/Services	\$108,829,066	\$50,309,279	\$0	\$0	\$50,309,279	\$16,570,291	\$108,829,066
CGMP 05 Terminal/SCW/Gateway	\$1,042,507,452	\$1,042,670,036	\$0	(\$162,584)	\$1,042,507,452	\$1,042,115,888	\$1,042,507,452
CGMP 06 Parking Garage, Roadways, CUP	\$403,477,666	\$405,856,439	\$0	(\$2,378,773)	\$403,477,666	\$400,523,181	\$403,477,666
CGMP 07 TRP Baggage Handling System	\$96,289,987	\$96,578,430	(\$288,443)	\$0	\$96,289,987	\$96,289,987	\$96,289,987
CGMP 10 South Concourse East/Tunnel Shell	\$540,188,144	\$543,319,572	(\$3,131,428)	\$0	\$540,188,144	\$194,149,074	\$540,188,144
CGMP 11, 11A & 11B Apron Paving & Fueling	\$275,423,126	\$200,210,465	\$3,131,428	\$0	\$203,341,893	\$78,564,233	\$275,423,126
CGMP 19A Phase 3 NCP/Tunnel Buildout	\$347,386,114	\$58,900,309	\$0	\$0	\$58,900,309	\$1,929,103	\$347,386,114
CGMP 20 NCP Phase 2 Airfield Paving & Jet Fuel	\$77,645,774	\$0	\$77,645,774	\$0	\$77,645,774	\$0	\$77,645,774
Total Program Construction	\$3,773,964,577	\$3,285,981,772	\$77,357,331	(\$8,491,351)	\$3,354,847,752	\$2,711,621,324	\$3,773,964,577
TRP Owner Procurement	\$5,465,472	\$5,335,714	\$0	\$0	\$5,335,714	\$4,808,421	\$5,465,472
NCP Owner Procurement	\$2,655,266	\$2,655,266	\$0	\$0	\$2,655,266	\$1,860,182	\$2,655,266
Security Checkpoint Equipment	\$12,751,472	\$11,751,472	\$0	\$0	\$11,751,472	\$7,848,061	\$12,751,472
Automated Security Exit Door Equipment	\$672,000	\$0	\$0	\$0	\$0	\$0	\$672,000
TRP Soft Cost	\$378,283,065	\$305,211,004	(\$326,382)	\$0	\$304,884,622	\$282,573,233	\$378,283,065
NCP Soft Cost	\$185,593,794	\$128,433,271	\$53,597	\$0	\$128,486,868	\$95,084,156	\$185,593,794
Total Program Soft Cost	\$585,421,069	\$453,386,727	(\$272,785)	\$0	\$453,113,942	\$392,174,053	\$585,421,069
CGMP 2G CMAR Preconstruction Phase 4	\$1,414,757	\$1,414,757	\$0	\$0	\$1,414,757	\$84,886	\$1,414,757
NCP Soft Cost Phase 4	\$12,758,297	\$2,064,866	\$10,693,431	\$0	\$12,758,297	\$83,429	\$12,758,297
Total Phase 4 Planning Cost	\$14,173,054	\$3,479,623	\$10,693,431	\$0	\$14,173,054	\$168,315	\$14,173,054
TRP Owner Reserve	\$39,897,662	\$0	\$0	\$0	\$0	\$0	\$39,897,662
NCP Owner Reserve	\$38,516,700	\$0	\$0	\$0	\$0	\$0	\$38,516,700
Total Program Owner Reserve	\$78,414,362	\$0	\$0	\$0	\$0	\$0	\$78,414,362
Total ARP Program Budget	\$4,451,973,062	\$3,742,848,122	\$87,777,977	(\$8,491,351)	\$3,822,134,748	\$3,103,963,692	\$4,451,973,062

*Pending Commitments for Final/Closeout Revisions to CGMPs 5, 6, 09A & 12 will reduce the CGMPs values/commitments to the 09/02/21 Budget

Project Statistics Update



TRP/NCP Trade Staffing
Trade Workers 539 (11/05/2021)
11,042,537 Hours Worked as of 10/31/2021

Contract Local/Non-Local Awarded Statistics

Local Trades	Dollar Value	Trade Count	Percentage
Total Local (Wasatch Front) Contractors	\$1,400,094,239	125	67%
Total Out of State Contractors	\$680,946,134	30	33%
Total Contract Awards	\$2,081,040,373	155	100%

Contract Union/Merit Shop Awarded Statistics

Union Trades	Dollar Value	Trade Count	Percentage
Total Union Contractors	\$698,423,765	36	34%
Total Merit Shop Contractors	\$1,382,616,608	119	66%
Total Contract Awards	\$2,081,040,373	155	100%

Concourse 'A' East/ Central Tunnel/Airfield



Central Tunnel Concrete Structure

- **Concrete Mat (Bottom) Slab Concrete Placement Continuing**
- **Lid Concrete Placement Continuing**
- **Wall Waterproofing and Protection Board Continuing**
- **Wall Backfill Progressing**

Concourse 'A' East

- **Structural Steel Rough Erection Complete**
- **Continuing Elevated Concrete Slab Placement**
- **Mechanical, Electrical and Plumbing Rough-in Progressing**
- **Baggage Handling System Header Steel Continuing**
- **Started Baggage Handling System Conveyor Installation**
- **Spray-on Insulation and Fire Proofing Continuing**
- **Exterior Studs, Sheathing and Vapor Carrier Progressing**

Concourse 'A' East/ Central Tunnel/Airfield



Airfield

- **Site Utilities Progressing**
- **Hydrant Fuel System Pipe and Fuel Vault Installation Progressing**
- **Airfield Paving at East Side of Construction Site continuing**
- **Airfield Paving South Side of Concourse Continues**
- **Airfield Paving for East/West Taxiway Underway**

Concourse 'B' Hardstand Expansion / Terminal Level 1 Bag Check



Hardstand Ramps

- **All Ramps and Bus Shelters in Operation 11/1/2021**

Lower-Level Hardstand Holdroom

- **Complete and in Operation for Other Airlines as of 11/1/2021**

Boarding Level Hardstand Holdroom

- **All Work Complete and Utilized by Delta as of 11/1/2021**

Terminal Level 1 Baggage Check-in

- **Complete and Open 11/1/2021**
- **Delta Staffing 3 Positions**
- **3 Positions Available for Other Airlines**
- **Terminal Level 1 Security Checkpoint Staffed and Available**

Phase 3 Procurement and Phase 4 Design



Phase 3 (Concourse 'B' East 8 Gate) Procurement

- **CGMP 20 for Apron Paving and Fueling Approved**
- **Reviewing Building Trade Recommendations to Award**
- **CGMP 19A Target Approval Date 12/16/2021**

Phase 4 (Concourse 'B' East 16 Gate) Design

- **Program Validation Final Report Received 10/15/2021**
- **Started Schematic Design – Issue Documents 12/20/2021**
- **Developing Program Options to Address Security Checkpoint Queue Space, Baggage Services Offices and Airline Ticket Offices**
- **Schematic Design Estimate Due 2/16/2022**

Overall Phase 2 and Phase 3 Phased Delivery

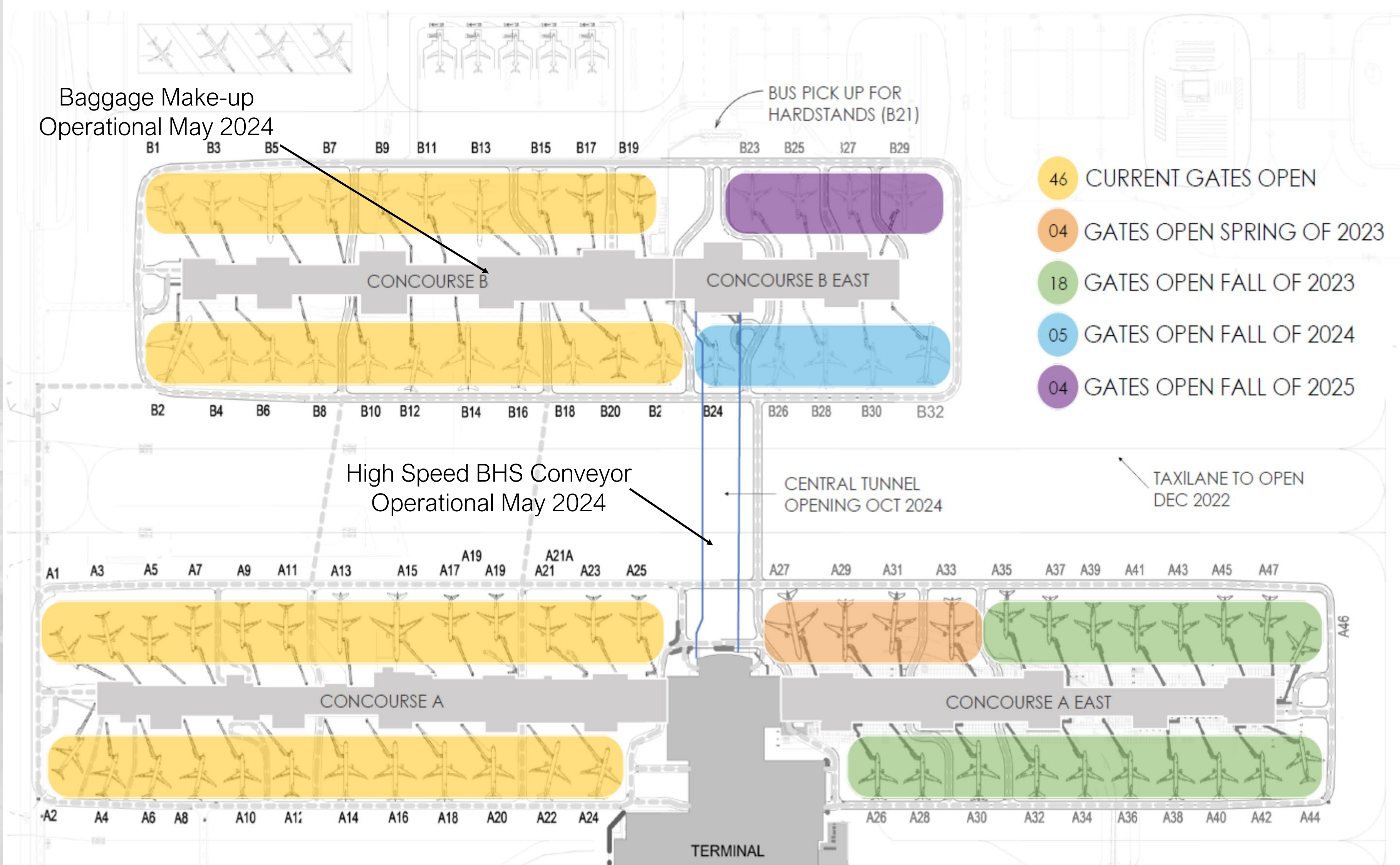

- 46 CURRENT GATES OPEN
- 04 GATES OPEN SPRING OF 2023
- 18 GATES OPEN FALL OF 2023
- 05 GATES OPEN FALL OF 2024
- 04 GATES OPEN FALL OF 2025

Concourse A East and Site



Central Tunnel Progress



Apron Paving Progress



Concourse A East – Area A



Concourse 'B' Hardstand Holdrooms



Level 2 Entrance to Ramp to Level 1



Level 1 Holdroom - Ready for Passengers



Level 2 Hardstand Holdroom - Need Help?



Level 1 Concession Area

Terminal Level 1 Baggage Check-in

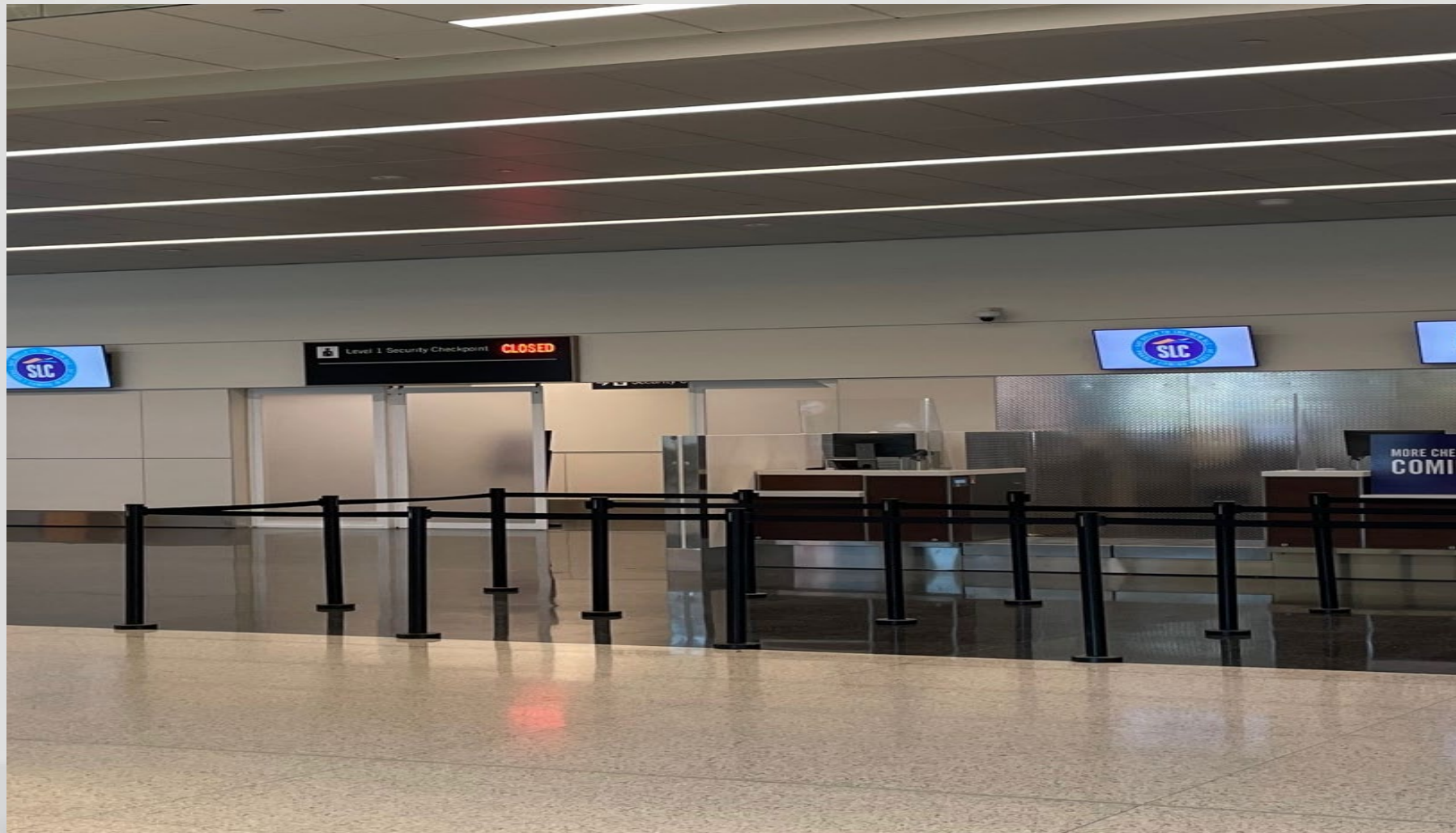

Level 1 Security Checkpoint Entrance

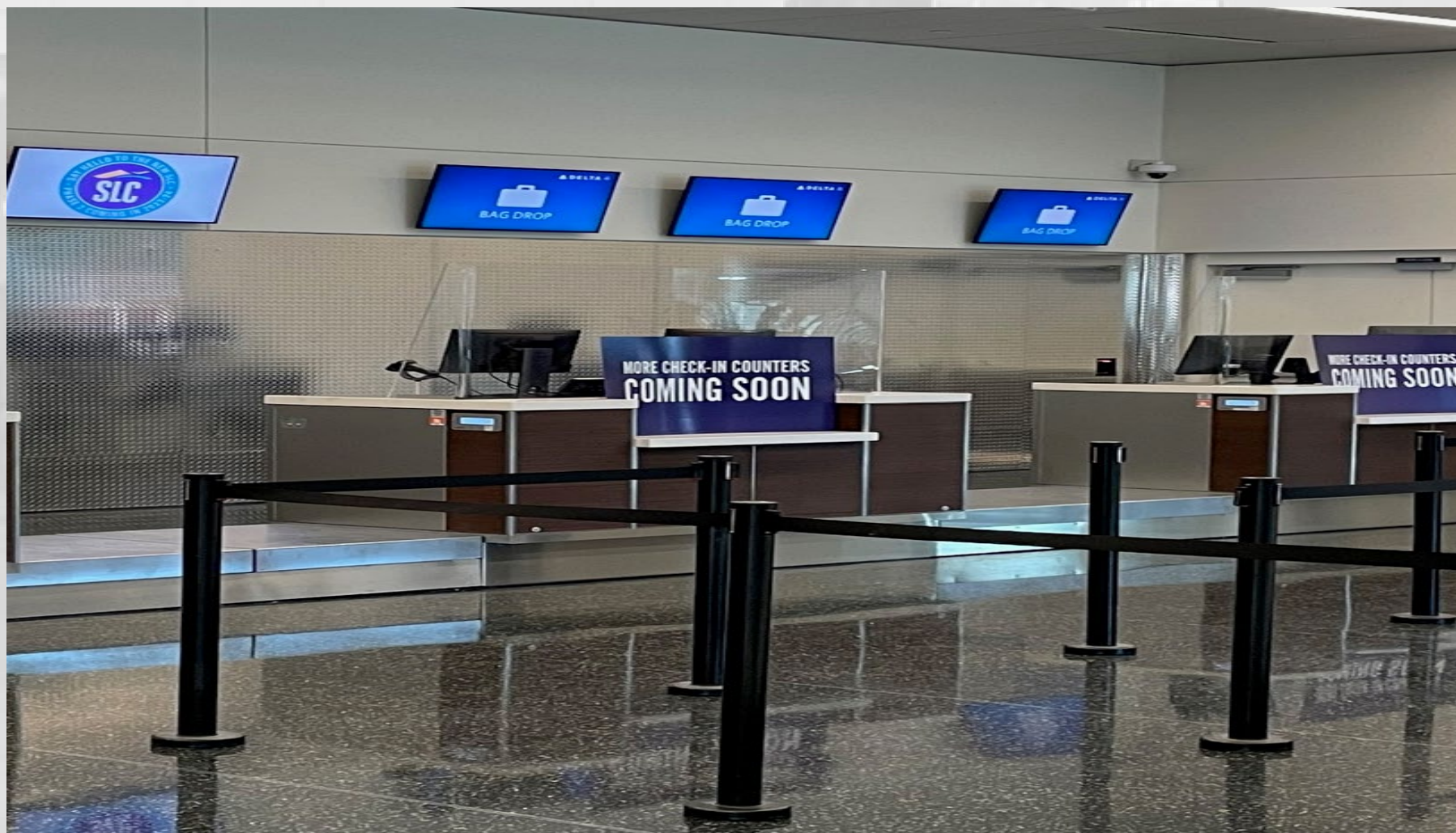

Level 1 Bag Check-in

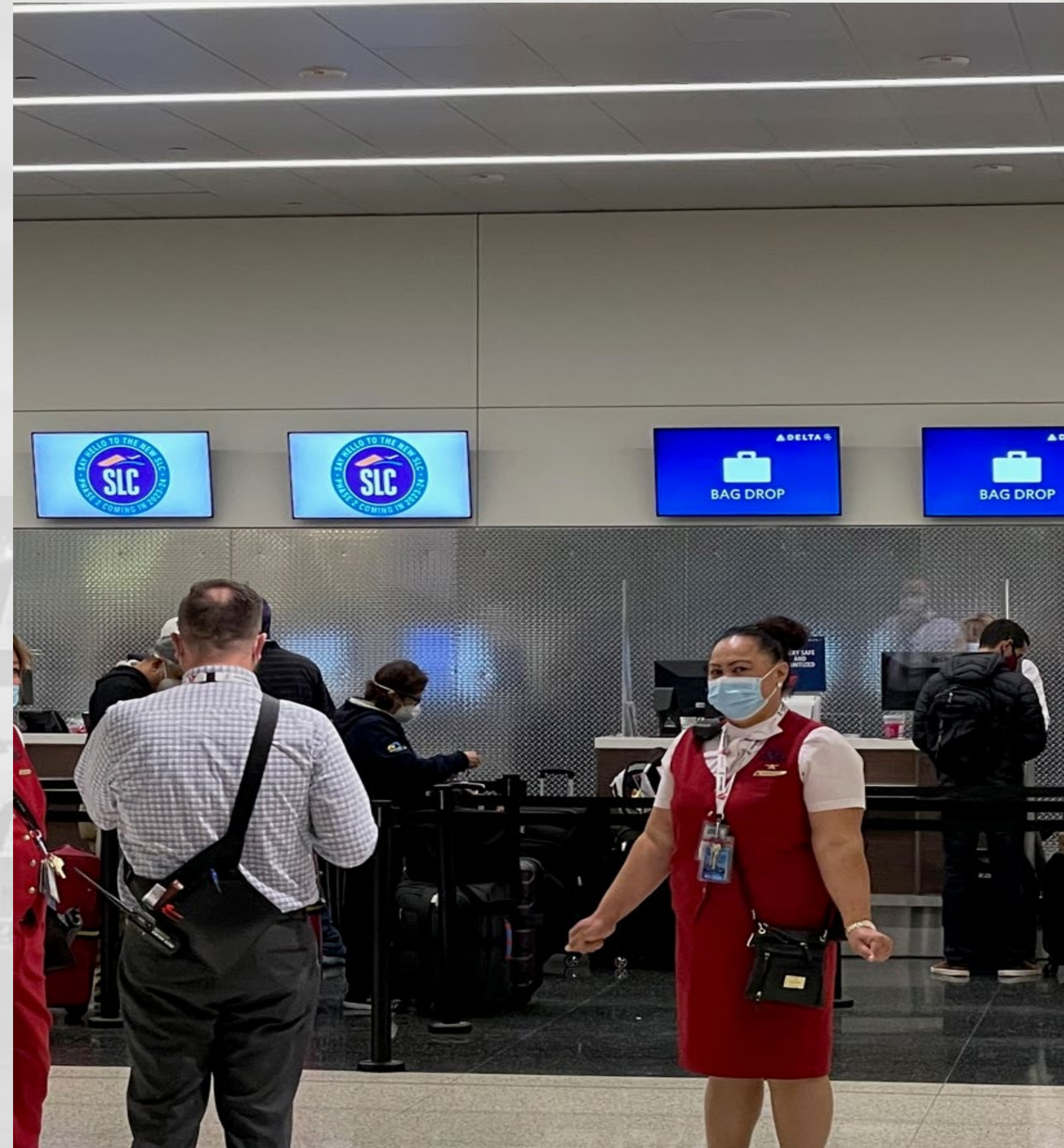

Level 1 Bag Check-in Open for Business

AGENDA: DISCUSSION ITEM (C)
DATE: 17 November 2021
TO: Airport Advisory Board
FROM: Bill Wyatt, Executive Director
SUBJECT: **Preliminary Budget Briefing**

Brian Butler, Finance Director, SLCDA will present a Preliminary Budget Briefing update (presentation on file.)



PRELIMINARY BUDGET BRIEFING FY2023
AIRPORT ADVISORY BOARD

11/17/2021



FY 2023 Budget Goals & Objectives - Budget Drivers



- Forecast revenues and expenses on information known today with reasonable assumptions for the future
- Assumptions and actual results will be reviewed in a timely manner and appropriate actions taken
- Control costs and look for ways to strengthen non aeronautical revenue growth
- Continue to stabilize rates and charges through ARPA Grants

FY 2023 Budget Key Dates



- October 19th Budget Kick Off Meeting
- November 5th Staffing, Capital Equipment, and Capital Projects Due
- November 15th First Directors Retreat
- November 24th Travel Requests Due
- December 13th Operating and Expense Budgets Due
- January 1st Airline Forecasts Due
- January 10th Second Directors Retreat
- January 14th Revenue Forecasts Due
- February 7th Third and Final Directors Retreat
- February 25th Draft Budget Book Due
- March 2nd Airport Presents Budget to Airlines
- March 7th or 8th Airport to Meet with Finance Sub-Committee
- March 16th Airport Advisory Board Budget Presentation
- April TBD Airport to Brief Mayor's Office and City Council

What Drives the Budget? Enplanements, Landed Weights, Airline Use Agreement (AUA), and the Plan of Finance

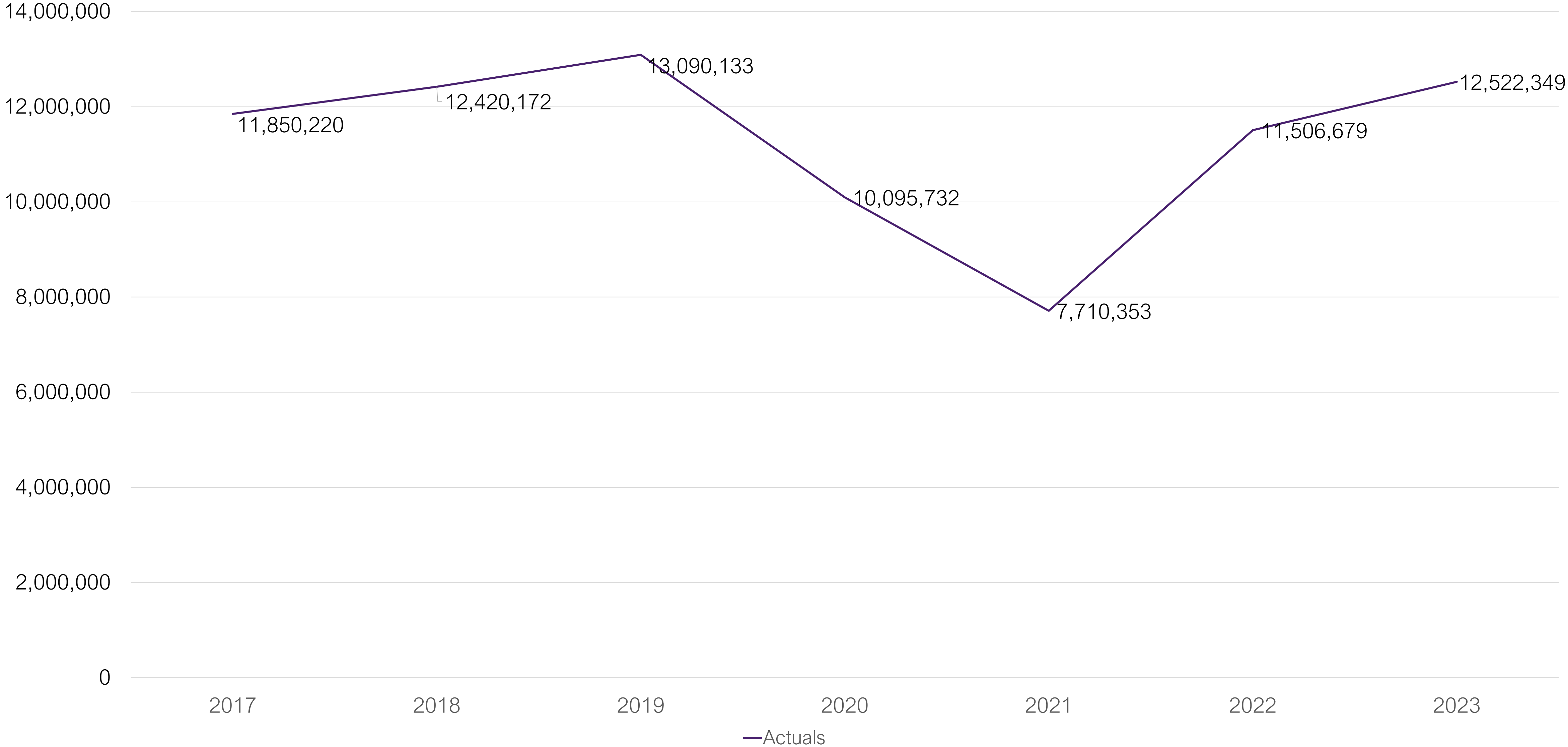



Questions?

AGENDA: DISCUSSION ITEM (D)
DATE: 17 November 2021
TO: Airport Advisory Board
FROM: Bill Wyatt, Executive Director
SUBJECT: **Concessions Program Update**

Shane Andreasen, Director of Administration and Commercial Services, SLCD
will provide a Concessions Program Update (presentation on file.)



AIRPORT ADVISORY BOARD CONCESSIONS PROGRAM UPDATE
SHANE ANDREASEN, DIRECTOR OF ADMINISTRATION & COMMERCIAL SERVICES

November 17, 2021



Monthly Concession Sales July 2018 – August 2021

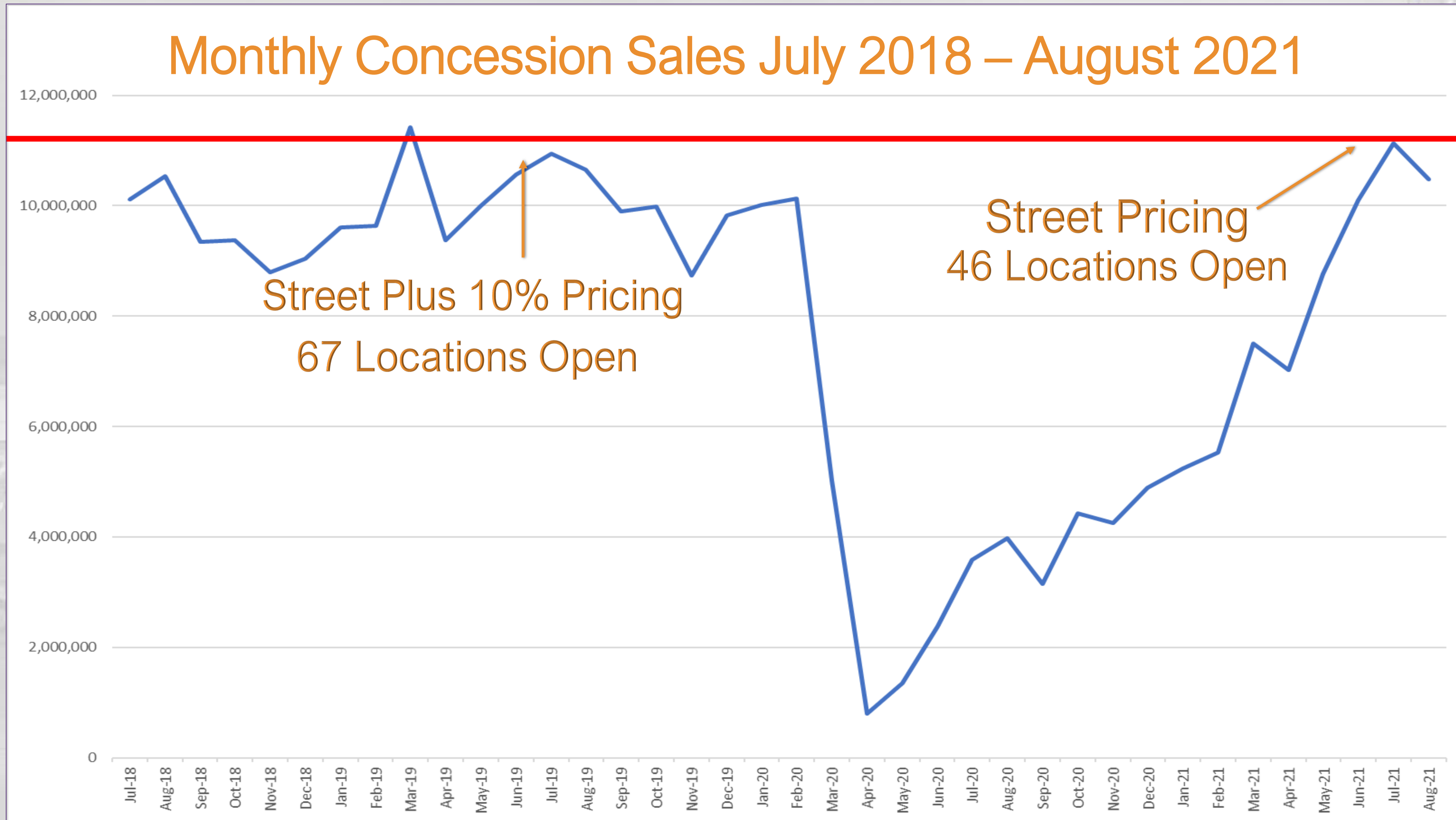

Open & Operating



(85% of Program Complete)

- 50 of 59 Locations
- Recent Openings
(Bruges Belgian Bistro, Panda Express, Pizzeria Limone & Panera Bread)
- Regular Business Hours except recent openings due to staffing

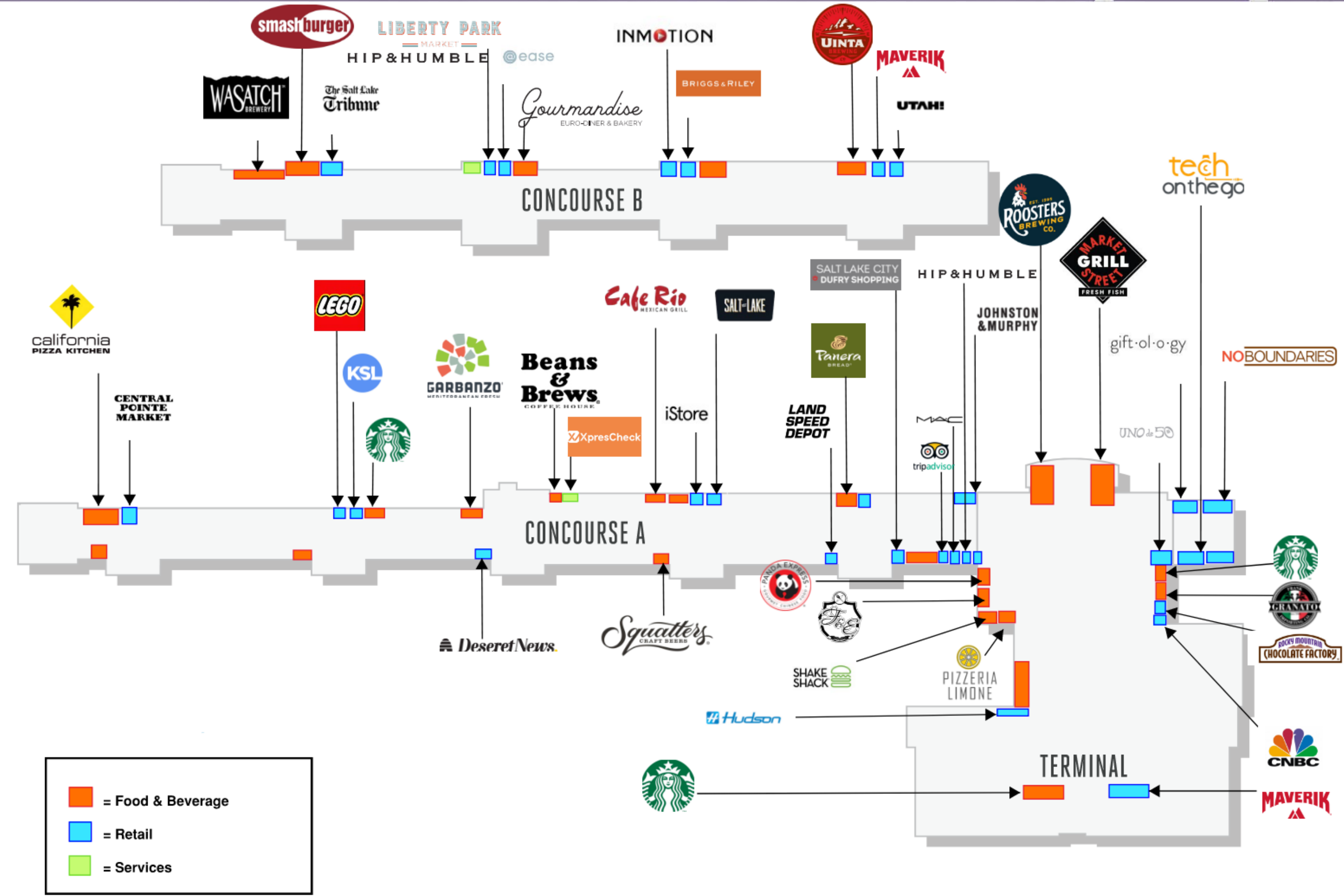

Under Construction and Design Review / Permitting



Under Construction (14% of Program)

- Pick Up Stix (B - Late November)
- White Horse Spirits (A - Late November)
- FRYE (A - Mid December)
- TUMI (A - Mid December)
- Coach (A - Mid December)
- Beecher's Cheese (A - Mid December)
- Blue Lemon (Pre - Mid December)
- Jamba Juice (A - Late December)

(Shipping, material and staffing delays are impacting opening dates)

Design Review (2% of Program)

- Treat by XpresSpa (B - March 1, 2022)
- XpresCheck (Gateway - TBD)

Bruges Belgian Bistro (Concourse A)



Photo taken 11.4.2021

Pick Up Stix (Concourse B)



Photo taken 11.4.2021

FRYE (Concourse A)



Photo taken 10.19.2021

TUMI (Concourse A-Nub)



Photo taken 10.19.2021

Coach (Concourse A)



Photo taken 10.19.2021

White Horse Spirits & Kitchen (Concourse A)



Photo taken 11.4.2021

Beecher's Handmade Cheese (Concourse)



Photo taken 10.19.2021

Blue Lemon (Pre-Security)



Photo taken 10.19.2021

Jamba Juice (Concourse A)



Photo taken 10.19.2021

Phase II Request for Proposals



- 19 Locations (23,873 Square Feet)
- Food & Beverage (17,352 SF - 73%): 2 Full-Service w/ Alcohol, 1 Fast Food Global Hamburger Chain, 2 Specialty Coffee, 4 Quick Service/Fast Casual Restaurants & 3 Snack
- Retail & Services (6,521 SF - 27%): 3 Specialty Retail, 3 News & Gift, and 1 Spa or Wellness
- Proposals Due January 21, 2022
- Openings November 7, 2023 (temp kiosks May 2023)

Food & Beverage
Convenience Retail
Specialty Retail

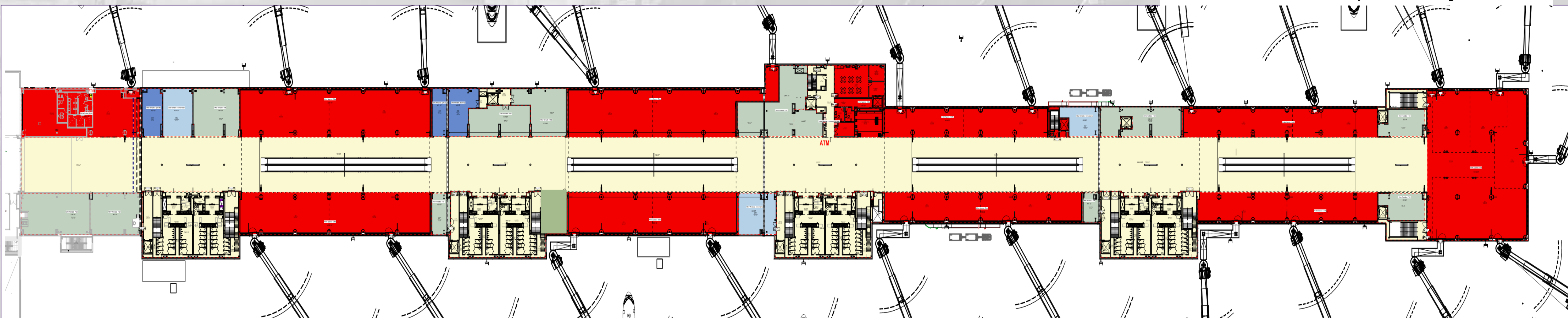



Questions?

SALT LAKE CITY AIRPORT BOARD

AGENDA: DISCUSSION ITEM (E)
DATE: 17 November 2021
TO: Airport Board
FROM: Bill Wyatt, Executive Director
SUBJECT: **Nominations for Board Chair and Vice-Chair**

The Board will be asked to make nominations for a new Board Chair and Vice-Chair. Voting will be conducted at the January 2022 meeting.



Advisory Board
Meeting

November 17, 2021

Information

SALT LAKE CITY DEPARTMENT OF AIRPORTS
(An Enterprise Fund of Salt Lake City Corporation)
Statements of Net Position (Unaudited)
(Amounts in Thousands)

<i>As of September 30,</i>	2021	2020
ASSETS		
Current Assets		
Cash and cash equivalents	\$ 206,443	\$ 86,372
Restricted cash and cash equivalents	605,111	29,744
Restricted investments	34,241	21,760
Investments	-	102,091
Airline and rental fees receivable	29,921	22,844
Loans receivable	7,347	-
Other assets	7,173	153
Total current assets	890,236	262,964
Noncurrent Assets		
Restricted cash and cash equivalents	140,653	107,553
Restricted investments	171,074	65,322
Investments	921	20,702
Loans receivable	31,895	23,193
Other assets	2,633	1,367
Total noncurrent assets and investments	347,176	218,137
Capital assets		
Land	111,696	111,696
Building and improvements	3,445,888	1,419,993
Equipment	341,458	169,490
Construction in progress	393,174	2,516,839
Total capital assets - at cost	4,292,216	4,218,018
Less accumulated depreciation	863,212	1,095,079
Net capital assets	3,429,004	3,122,939
Total noncurrent assets	3,776,180	3,341,076
Total Assets	4,666,416	3,604,040
Deferred Outflows of Resources	4,413	4,521
Total Assets and Deferred Outflows of Resources	\$ 4,670,829	\$ 3,608,561

SALT LAKE CITY DEPARTMENT OF AIRPORTS
(An Enterprise Fund of Salt Lake City Corporation)
Statements of Net Position (Unaudited)
(Amounts in Thousands)

<i>As of September 30,</i>	2021	2020
LIABILITIES		
Current Liabilities		
Accounts payable	\$ 10,454	\$ 28,545
Accrued compensation	2,954	2,469
Interest payable	23,180	23,194
Other accrued liabilities	15,146	44,167
Current bonds payable	20,345	-
Total current liabilities	72,079	98,375
Noncurrent Liabilities		
Revenue bonds payable	3,151,776	2,038,302
Noncurrent compensation liability	4,360	3,801
Net pension liability	1,152	8,431
Other accrued liabilities	24,878	49,574
Total noncurrent liabilities	3,182,166	2,100,108
Total Liabilities	3,254,245	2,198,483
Deferred Inflows of Resources		
Deferred inflows - revenue collected in advance	7,405	5,893
Deferred inflows - pension	8,944	4,993
Total Deferred Inflows of Resources	16,349	10,886
NET POSITION		
Net investment in capital assets	1,155,945	1,260,835
Restricted for		
Capital projects	52,022	48,170
Debt service	323,130	175,833
Unrestricted	(130,862)	(85,646)
Net Position	1,400,235	1,399,192
Total Liabilities, Deferred Inflows of Resources, and Net Position	\$ 4,670,829	\$ 3,608,561

SALT LAKE CITY DEPARTMENT OF AIRPORTS

(An Enterprise fund of Salt Lake City Corporation)

Statements of Revenues, Expenses, and Changes in Fund Net Position (Unaudited)

(Amounts in Thousands)

<i>for the Three month period ended September,</i>	2021	2020
Operating Revenues		
Airline revenue	\$ 41,519	\$ 25,123
Terminal concessions	5,698	1,730
Landside concessions	22,102	8,576
Lease revenue	2,284	1,437
General aviation	840	801
State aviation tax	794	465
Other revenue	1,262	839
Operating revenues	74,499	38,971
Less airline revenue sharing	(3,379)	(1,435)
Total operating revenues	71,120	37,536
Operating Expenses		
Salaries and benefits	13,661	12,606
Materials and supplies	2,165	1,736
Maintenance contracts	1,914	2,049
Charges and services	5,187	3,203
Utilities	1,261	879
Inter-governmental	4,237	3,734
Other expenses	3,085	1,706
Total operating expenses before depreciation	31,510	25,913
Operating Income Before Depreciation	39,610	11,623
Depreciation Expense	49,217	14,324
Operating Loss	(9,607)	(2,701)
Non-Operating Revenues (Expenses)		
Passenger facility charges	12,315	4,825
Customer facility charges	2,889	1,045
Interest income	177	29
Interest expense	(21,802)	(27,345)
Bond issuance costs	(4,150)	-
Contribution of capital assets	239	-
Other revenue (expenses), net	52	41
Net non-operating loss	(10,280)	(21,405)
Capital Contributions		
Contributions and grants	3,900	(7,274)
Total capital contributions	3,900	(7,274)
Net Position		
Decrease in net position	(15,987)	(31,380)
Net Position, beginning of period	1,416,222	1,430,572
Net Position, end of period	\$ 1,400,235	\$ 1,399,192

SALT LAKE CITY DEPARTMENT OF AIRPORTS

(An Enterprise fund of Salt Lake City Corporation)

OPERATING REVENUES AND EXPENDITURES TO BUDGET (Unaudited)

(Amounts in Thousands)

	Jul 2021 - Sep 2021 ACTUALS	Jul 2021 - Sep 2021 BUDGET	SURPLUS/ DEFICIT	PERCENT CHANGE
Revenues				
Landing Fees	\$ 16,767	\$ 14,276	\$ 2,491	17.4%
Fuel Farm	577	450	127	28.3%
Aircraft Remain Overnight Fees	143	114	29	25.7%
Cargo Bldg. & Ramp Use Fee	422	436	(14)	-3.3%
Security Charges to TSA	53	85	(32)	-37.7%
Extraordinary Service Charges	12	10	2	17.9%
Passenger Boarding Bridges	349	436	(87)	-20.0%
Tenant Telephone Fees	15	16	(1)	-5.3%
Terminal Rents	22,940	23,701	(761)	-3.2%
General Aviation Hangars	300	318	(18)	-5.5%
FBO Hangars/Fuel Oil Royalty	180	136	44	32.2%
Flight Kitchens	524	326	198	60.6%
Other Buildings & Office Space	1,438	1,492	(54)	-3.6%
Food Service & Vending	3,374	2,338	1,036	44.3%
News/Gift Shop	2,150	1,192	958	80.3%
Car Rental	10,172	7,152	3,020	42.2%
Leased Site Areas	1,113	966	147	15.2%
Auto Parking/Ground Transportation	11,921	7,978	3,943	49.4%
Advertising	174	63	111	176.8%
State Aviation Fuel Tax	794	510	284	55.7%
Military	39	39	-	0.0%
Glycol Recycling Sales	87	60	27	45.5%
Auxiliary Airport Fuel Sales	361	376	(15)	-3.9%
Other	594	655	(61)	-9.3%
Less: Airline Revenue Sharing	(3,379)	(595)	(2,784)	468.09%
Total Operating Revenues	71,120	62,530	8,590	13.7%
Expenses				
Salary & Wages	9,371	10,830	1,459	13.5%
Employee Benefits	4,591	4,880	289	5.9%
Maintenance Supplies	1,075	2,161	1,086	50.3%
Automotive Supplies	780	1,002	222	22.1%
Other Supplies	310	784	474	60.5%
Insurance Premiums	2,539	1,222	(1,317)	-107.7%
Janitorial Service	988	3,543	2,555	72.1%
Maintenance Contracts	925	2,021	1,096	54.2%
Other Contractual Services	2,435	4,063	1,628	40.1%
Professional & Tech Services	2,753	5,908	3,155	53.4%
Utilities	1,261	1,890	629	33.3%
Administrative Service Fee	639	383	(256)	-66.9%
Aircraft Rescue Fire Fighting	1,460	1,460	0	0.0%
Police Services	2,137	2,137	0	0.0%
Other Expenses	547	673	126	18.7%
Contingency Reserve	-	250	250	100.0%
Operating Expenses Before Capitalized Salaries	31,811	43,207	11,396	26.4%
Capitalized Salaries	301	301	-	0.0%
Total Operating Expenses	31,510	42,906	11,396	26.6%
Operating Income	\$ 39,610	\$ 19,624	\$ 19,986	101.8%

SALT LAKE CITY DEPARTMENT OF AIRPORTS

(An Enterprise fund of Salt Lake City Corporation)

OPERATING REVENUES AND EXPENDITURES TO PRIOR YEAR (Unaudited)

(Amounts in Thousands)

	Jul 2021 - Sep 2021	Jul 2020 - Sep 2020	DOLLAR CHANGE	PERCENT CHANGE
Revenues				
Landing Fees	\$ 16,767	\$ 11,524	\$ 5,243	45.5%
Fuel Farm	577	135	442	328.0%
Aircraft Remain Overnight Fees	143	111	32	28.8%
Cargo Bldg. & Ramp Use Fee	422	435	(13)	-2.9%
Security Charges to TSA	53	160	(107)	-67.0%
Extraordinary Service Charges	12	57	(45)	-79.0%
Passenger Boarding Bridges	349	375	(26)	-7.0%
Tenant Telephone Fees	15	67	(52)	-77.9%
Terminal Rents	22,940	11,481	11,459	99.8%
General Aviation Hangars	300	342	(42)	-12.4%
FBO Hangars/Fuel Oil Royalty	180	130	50	38.4%
Flight Kitchens	524	270	254	94.0%
Other Buildings & Office Space	1,438	1,476	(38)	-2.6%
Food Service & Vending	3,374	1,107	2,267	204.8%
News/Gift Shops	2,150	602	1,548	257.2%
Car Rental	10,172	4,645	5,527	119.0%
Leased Site Areas	1,113	752	361	48.1%
Auto Parking/Ground Transportation	11,921	3,928	7,993	203.5%
Advertising	174	21	153	727.6%
State Aviation Fuel Tax	794	465	329	70.8%
Military	39	39	(0)	0.0%
Glycol Recycling Sales	87	57	30	53.0%
Auxiliary Airport Fuel Sales	361	328	33	10.1%
Other	594	464	130	28.0%
Less: Airline Revenue Sharing	(3,379)	(1,435)	(1,944)	135.5%
Operating Revenues	71,120	37,536	33,584	89.5%
Expenses				
Salary & Wages	\$ 9,371	\$ 8,673	\$ 698	8.1%
Employee Benefits	4,591	4,232	359	8.5%
Maintenance Supplies	1,075	969	106	10.9%
Automotive Supplies	780	571	209	36.5%
Other Supplies	310	196	114	58.0%
Insurance Premiums	2,539	1,469	1,070	72.8%
Janitorial Service	988	1,493	(505)	-33.8%
Maintenance Contracts	925	557	368	66.1%
Other Contractual Services	2,435	1,610	825	51.2%
Professional & Tech Service	2,753	1,593	1,160	72.8%
Utilities	1,261	879	382	43.5%
Administrative Service Fee	639	344	295	85.9%
Aircraft Rescue Fire Fighting	1,460	1,315	145	11.0%
Police Services	2,137	2,075	62	3.0%
Other Expenses	547	237	310	130.6%
Operating Expenses Before Capitalized Salaries	31,811	26,213	5,598	21.4%
Capitalized Salaries	301	300	1	0.3%
Total Operating Expenses	31,510	25,913	5,597	21.6%
Operating Income	\$ 39,610	\$ 11,623	\$ 27,987	240.8%

SALT LAKE CITY DEPARTMENT OF AIRPORTS

(An Enterprise fund of Salt Lake City Corporation)

Statements of Cash Flows

(Amounts in Thousands)

<i>For the month ended September 30,</i>	2021	2020
Cash Flows from Operating Activities		
Cash received from providing services	\$ 69,020	\$ 38,908
Cash paid for services for intra-governmental charges	(1,834)	(1,315)
Cash paid to suppliers	(23,527)	(19,412)
Cash paid to employees	(12,061)	(11,172)
Net cash from operating activities	31,598	7,009
Cash Flows from Investing Activities		
Cash paid for investments	(106,468)	(163,587)
Cash proceeds from investments	4,450	178,937
Interest received on investments and concession loans	10	442
Payments for concession loans	(593)	(15,181)
Payments received on concession loans	1,952	-
Net cash from investing activities	(100,649)	610
Cash Flows from Capital and Related Financing Activities		
Purchase of capital equipment	(1,557)	(3,636)
Payments for acquisition and construction of capital assets	(138,802)	(200,836)
Proceeds from issuance of revenue bonds payable	1,139,949	-
Payment for capital assets contributed to TSA	(239)	-
Payment on line of credit	(267,600)	-
Interest paid on bonds and line of credit	(46,389)	(46,389)
Bond issuance costs	(1,418)	-
Passenger facility charges	12,800	3,325
Customer facility charges	4,116	2,026
Proceeds from sale of capital assets and equipment	52	-
Contributions and grants	27,554	6,082
Net cash used for capital and related financing activities	728,465	(239,428)
Net (Decrease) in Cash and Cash Equivalents	659,414	(231,809)
Cash and Cash Equivalents - Beginning of Year	292,793	455,477
Cash and Cash Equivalents - End of Year	\$ 952,207	\$ 223,669

SALT LAKE CITY DEPARTMENT OF AIRPORTS

(An Enterprise fund of Salt Lake City Corporation)

Statements of Cash Flows (Unaudited)

(Amounts in Thousands)

<i>for the Three month period ended September,</i>	2021	2020
Reconciliation of Operating Income to Net		
Cash from Operating Activities		
Operating loss	\$ (9,607)	\$ (2,701)
Adjustments to reconcile operating loss to net cash from operating activities		
Depreciation	49,217	14,324
Changes in assets and liabilities		
Airline and rental fee receivable	2,265	4,374
Other assets	960	(5,256)
Deferred outflows	-	-
Accounts payable	(11,776)	(5,487)
Accrued compensation	-	-
Other accrued liabilities	334	1,024
Deferred inflows	136	738
Deposits and advance rentals	69	(7)
Net cash from operating activities	31,598	7,010
Schedule of Non-cash Transactions Affecting Net Position		
Contributions and grants	(30,304)	(13,355)
Passenger facility charges (includes interest)	(3,844)	-
Customer facility charges (includes interest)	(2,460)	(1,788)
Bond issuance costs	(1,592)	-
Contributions of capital assets	(239)	-
Total Noncash Transactions Affecting Net Position	\$ (38,439)	\$ (15,143)



**SALT LAKE CITY INTERNATIONAL AIRPORT
AIR TRAFFIC STATISTICS AND ACTIVITY REPORT
NINE MONTHS ENDED SEPTEMBER 2021**

	September 2021	CHANGE	YTD 2021	CHANGE	12 MO ROLLING Ending 09/2021	CHANGE
PASSENGERS						
<i>DOMESTIC</i>						
Enplaned - Local	627,347	116.83%	5,101,261	67.82%	6,075,754	21.79%
Enplaned - Connections	398,236	96.84%	2,983,458	79.41%	3,591,681	20.27%
Less International	-21,210		-198,283		-237,219	
Enplaned	1,004,373	106.63%	7,886,436	72.13%	9,430,216	21.92%
Deplaned - Local	622,030	116.00%	5,101,366	68.27%	6,072,183	21.31%
Deplaned - Connection	398,236	96.84%	2,983,458	79.41%	3,591,681	20.27%
Less International	-20,269		-204,094		-238,988	
Deplaned	999,997	106.26%	7,880,730	72.90%	9,424,876	21.89%
TOTAL DOMESTIC	2,004,370	106.44%	15,767,166	72.51%	18,855,092	21.90%
<i>INTERNATIONAL</i>						
Enplaned	21,210	279.90%	198,283	63.81%	237,219	-1.35%
Deplaned	20,269	271.02%	204,094	49.48%	238,988	-7.93%
TOTAL INTERNATIONAL	41,479	275.51%	402,377	56.21%	476,207	-4.77%
TOTAL PASSENGERS	2,045,849	108.35%	16,169,543	72.07%	19,331,299	21.07%
LANDED WEIGHT						
Air Carriers	1,300,703,080	44.37%	10,985,641,092	43.83%	13,995,053,490	24.28%
Cargo Carriers	101,384,658	-3.01%	947,563,895	1.66%	1,351,571,784	5.33%
TOTAL LANDED WEIGHT (LBS)	1,402,087,738	39.44%	11,933,204,987	39.25%	15,346,625,274	22.34%
MAIL						
Enplaned	2,858,791	-18.80%	25,659,817	2.65%	34,209,578	7.60%
Deplaned	1,321,965	-41.87%	12,405,645	-13.69%	18,282,317	-0.70%
TOTAL MAIL (LBS)	4,180,756	-27.85%	38,065,462	-3.31%	52,491,895	4.56%
CARGO						
Enplaned	16,634,743	-6.38%	153,716,041	1.99%	213,751,366	4.85%
Deplaned	17,000,551	-4.91%	147,585,179	-2.66%	205,256,813	-1.04%
TOTAL CARGO (LBS)	33,635,294	-5.64%	301,301,220	-0.34%	419,008,179	1.88%
MAIL & CARGO						
Enplaned	8,317	-6.38%	76,858	1.99%	106,876	4.85%
Deplaned	8,500	-4.91%	73,793	-2.66%	102,628	-1.04%
TOTAL MAIL & CARGO (TONS)	16,817	-5.64%	150,651	-0.34%	209,504	1.88%
AIRCRAFT OPERATIONS						
Passenger Aircraft	22,122	38.35%	188,230	39.42%	241,122	21.53%
All-Cargo Aircraft	1,622	19.44%	15,178	1.72%	20,962	2.50%
General Aviation	6,181	-2.37%	52,481	6.10%	68,153	6.21%
Military	262	-17.87%	2,221	-2.46%	2,928	4.68%
TOTAL AIRCRAFT OPERATIONS	30,187	25.79%	258,110	27.98%	333,165	16.56%

**SALT LAKE CITY INTERNATIONAL AIRPORT
PASSENGER TRAFFIC REPORT
NINE MONTHS ENDED SEPTEMBER 2021**

	September 2020	September 2021	% CHANGE	YTD 2020	YTD 2021	% CHANGE	12 MO ROLLING Ending 09/2021	% CHANGE
ENPLANED PASSENGERS								
AEROMEXICO	-	-	0.0%	11,436	-	-100.0%	-	-100.0%
ALASKA	1	12,782	1278100.0%	42,893	78,166	82.2%	83,482	21.9%
Horizon Air / Alaska	1,544	2,115	37.0%	6,608	21,701	228.4%	26,959	123.4%
Skywest / Alaska	7,129	7,952	11.5%	62,296	110,405	77.2%	127,433	21.9%
AMERICAN	27,000	53,808	99.3%	262,851	422,138	60.6%	501,629	24.0%
Compass	-	-	0.0%	6,563	-	-100.0%	-	-100.0%
Envoy Air	344	2,697	684.0%	733	18,347	2403.0%	18,347	2403.0%
American/Mesa Air	-	1,675	100.0%	-	10,606	100.0%	11,527	7795.2%
Republic	629	1,562	148.3%	629	4,714	649.4%	4,901	679.2%
SkyWest (American)	5,918	4,246	-28.3%	37,805	68,788	82.0%	93,010	64.6%
DELTA	276,908	569,788	105.8%	2,519,489	4,414,724	75.2%	5,277,866	20.5%
SkyWest (Delta Connection)	96,298	184,831	91.9%	829,482	1,420,268	71.2%	1,733,493	27.4%
Compass (Delta Connection)	-	-	0.0%	-	-	0.0%	-	-100.0%
FRONTIER	13,128	21,480	63.6%	98,191	183,184	86.6%	230,031	40.1%
JETBLUE	3,369	15,672	365.2%	100,373	144,603	44.1%	160,827	-16.7%
KLM ROYAL DUTCH AIRLINES	-	-	0.0%	-	-	0.0%	-	-100.0%
SOUTHWEST	40,594	100,763	148.2%	495,949	813,422	64.0%	946,778	20.2%
UNITED	6,231	17,882	187.0%	106,243	145,505	37.0%	173,127	19.1%
GoJet Airlines	-	-	0.0%	-	-	0.0%	-	-100.0%
Express Jet	-	-	0.0%	600	-	-100.0%	-	-100.0%
Mesa Airlines (United Express)	-	721	100.0%	5,650	7,621	34.9%	7,718	-44.8%
Republic Airways (United)	-	-	0.0%	1,953	3,114	59.4%	3,703	-70.8%
SkyWest (United Express)	12,554	27,609	119.9%	112,737	217,233	92.7%	266,424	37.8%
Trans States	-	-	0.0%	-	-	0.0%	-	0.0%
Charters	-	-	0.0%	255	180	-29.4%	180	-72.5%
West Coast Charters	-	0	0.0%	-	0	0.0%	0	0.0%
TOTAL ENPLANED PASSENGERS	491,647	1,025,583	108.6%	4,702,736	8,084,719	71.9%	9,667,435	21.2%
DEPLANED PASSENGERS								
AeroMexico	-	-	0.0%	11,393	-	-100.0%	-	-100.0%
ALASKA AIR	1	14,075	1407400.0%	41,585	79,973	92.3%	84,962	26.5%
Horizon Air / Alaska	1,598	2,406	50.6%	6,818	21,641	217.4%	26,838	119.2%
Skywest / Alaska	7,630	7,845	2.8%	65,636	109,744	67.2%	126,817	17.4%
AMERICAN	26,918	55,140	104.8%	257,133	426,786	66.0%	504,646	24.8%
Compass	-	-	0.0%	6,494	-	-100.0%	-	-100.0%
Envoy Air (American)	278	2,402	764.0%	722	18,004	2393.6%	18,004	2393.6%
Mesa Air	-	1,251	100.0%	-	10,313	100.0%	11,310	7864.8%
Republic	583	1,575	170.2%	583	4,526	676.3%	4,709	707.7%
SkyWest (American)	6,004	4,403	-26.7%	39,017	69,094	77.1%	92,979	57.7%
DELTA	275,118	564,840	105.3%	2,528,935	4,405,815	74.2%	5,266,388	19.6%
SkyWest (Delta Connection)	96,082	182,943	90.4%	824,592	1,420,365	72.3%	1,733,989	27.4%
Compass (Delta Connection)	-	-	0.0%	-	-	0.0%	-	-100.0%
FRONTIER	13,426	21,712	61.7%	100,251	184,692	84.2%	231,339	38.4%
JETBLUE	3,090	14,549	370.8%	101,821	141,287	38.8%	158,440	-18.9%
KLM ROYAL DUTCH AIRLINES	-	-	0.0%	-	-	0.0%	-	-100.0%
SOUTHWEST	40,344	100,078	148.1%	487,441	807,719	65.7%	939,660	21.4%
UNITED	6,510	18,468	183.7%	101,975	147,955	45.1%	177,147	27.2%
GoJet Airlines	-	-	0.0%	-	-	0.0%	-	-100.0%
Express Jet	-	-	0.0%	582	-	-100.0%	-	-100.0%
Mesa Airlines / United Express	-	807	100.0%	5,597	8,952	59.9%	9,065	-34.2%
Republic Airways (United)	-	-	0.0%	2,037	3,051	49.8%	3,816	-70.9%
SkyWest (United Express)	12,715	27,772	118.4%	111,732	224,601	101.0%	273,448	41.5%
Trans States	-	-	0.0%	-	-	0.0%	-	0.0%
Charters	-	-	0.0%	190	306	61.1%	307	-55.2%
West Coast Charters	-	-	0.0%	-	-	0.0%	-	0.0%
TOTAL DEPLANED PASSENGERS	490,297	1,020,266	108.1%	4,694,534	8,084,824	72.2%	9,663,864	20.9%
TOTAL PASSENGERS*	981,944	2,045,849	108.3%	9,397,270	16,169,543	72.1%	19,331,299	21.1%
INTERNATIONAL - ENPLANED								
AEROMEXICO	-	-	0.0%	11,436	-	-100.0%	-	-100.0%
DELTA	5,583	21,210	279.9%	103,792	198,281	91.0%	237,217	23.7%
SkyWest (Delta Connection)	-	-	0.0%	5,736	-	-100.0%	-	-100.0%
Compass	-	-	0.0%	-	-	0.0%	-	-100.0%
KLM ROYAL DUTCH AIRLINES	-	-	0.0%	-	-	0.0%	-	-100.0%
Charters	-	-	0.0%	82	-	-100.0%	-	-100.0%
TOTAL ENPLANED INTERNATIONAL	5,583	21,210	279.9%	121,046	198,281	63.8%	237,217	-1.4%
INTERNATIONAL - DEPLANED								
AEROMEXICO	-	-	0.0%	11,393	-	-100.0%	-	-100.0%
DELTA	5,463	20,269	271.0%	115,851	204,092	76.2%	238,986	18.6%
SkyWest (Delta Connection)	-	-	0.0%	9,289	-	-100.0%	-	-100.0%
Compass	-	-	0.0%	-	-	0.0%	-	-100.0%
KLM ROYAL DUTCH AIRLINES	-	-	0.0%	-	-	0.0%	-	-100.0%
Charters	-	-	0.0%	-	-	0.0%	-	0.0%
TOTAL DEPLANED INTERNATIONAL	5,463	20,269	271.0%	136,533	204,092	49.5%	238,986	-7.9%
TOTAL INTERNATIONAL PASSENGERS	11,046	41,479	275.5%	257,579	402,373	56.2%	476,203	-4.8%

*Includes International

**SALT LAKE CITY INTERNATIONAL AIRPORT
NINE MONTHS ENDED SEPTEMBER 2021
Based on Total Enplanements**

MARKET SHARE

	September 2020	MARKET SHARE	September 2021	MARKET SHARE	YTD 2020	MARKET SHARE	YTD 2021	MARKET SHARE	12 MO ROLLING Ending 09/2020	12 MO ROLLING Ending 09/2021	MARKET SHARE
AEROMEXICO	-	0.00%	-	0.00%	11,436	0.24%	-	0.00%	23,549	-	0.00%
ALASKA	8,674	1.76%	22,849	2.23%	111,797	2.38%	210,272	2.60%	185,053	237,874	2.46%
AMERICAN	33,891	6.89%	63,988	6.24%	308,581	6.56%	524,593	6.49%	475,974	629,414	6.51%
DELTA	373,206	75.91%	754,619	73.58%	3,348,971	71.21%	5,834,992	72.17%	5,772,940	7,011,359	72.53%
FRONTIER	13,128	2.67%	21,480	2.09%	98,191	2.09%	183,184	2.27%	164,183	230,031	2.38%
JETBLUE	3,369	0.69%	15,672	1.53%	100,373	2.13%	144,603	1.79%	193,025	160,827	1.66%
KLM ROYAL DUTCH	-	0.00%	-	0.00%	-	0.00%	-	0.00%	2,393	-	0.00%
SOUTHWEST	40,594	8.26%	100,763	9.82%	495,949	10.55%	813,422	10.06%	787,777	946,778	9.79%
UNITED	18,785	3.82%	46,212	4.51%	227,183	4.83%	373,473	4.62%	369,613	450,972	4.66%
Charters	-	0.00%	-	0.00%	255	0.01%	180	0.00%	655	180	0.00%
TOTAL ENPLANEMENTS	491,647	100%	1,025,583	100%	4,702,736	100%	8,084,719	100%	7,975,162	9,667,435	100%

PERCENT CHANGE YOY

	September 2020	September 2021	PERCENT CHANGE	YTD 2020	YTD 2021	PERCENT CHANGE	12 MO ROLLING Ending 09/2020	12 MO ROLLING Ending 09/2021	PERCENT CHANGE
AEROMEXICO	-	-	100.00%	11,436	-	100.00%	23,549	-	-100.00%
ALASKA	8,674	22,849	163.42%	111,797	210,272	88.08%	185,053	237,874	28.54%
AMERICAN	33,891	63,988	88.81%	308,581	524,593	70.00%	475,974	629,414	32.24%
DELTA	373,206	754,619	102.20%	3,348,971	5,834,992	74.23%	5,772,940	7,011,359	21.45%
FRONTIER	13,128	21,480	63.62%	98,191	183,184	86.56%	164,183	230,031	40.11%
JETBLUE	3,369	15,672	365.18%	100,373	144,603	44.07%	193,025	160,827	-16.68%
KLM ROYAL DUTCH	-	-	0.00%	-	-	0.00%	2,393	-	-100.00%
SOUTHWEST	40,594	100,763	148.22%	495,949	813,422	64.01%	787,777	946,778	20.18%
UNITED	18,785	46,212	146.00%	227,183	373,473	64.39%	369,613	450,972	22.01%
Charters	-	-	#DIV/0!	255	180	-29.41%	655	180	-72.52%
TOTAL ENPLANEMENTS	491,647	1,025,583	108.6%	4,702,736	8,084,719	71.9%	7,975,162	9,667,435	21.2%

**SALT LAKE CITY INTERNATIONAL AIRPORT
LANDING ACTIVITY
NINE MONTHS ENDED SEPTEMBER 2021**

	September 2020	September 2021	CHANGE	YTD 2020	YTD 2021	CHANGE	12 MO ROLLING Ending 09/2021	% CHANGE
TOTAL NUMBER OF LANDINGS								
SCHEDULED CARRIERS								
AEROMEXICO	-	-	0.0%	109	-	-100.0%	-	-100.0%
ALASKA	-	123	100.0%	394	629	59.6%	699	17.9%
Horizon Air / Alaska	30	36	20.0%	138	408	195.7%	526	142.4%
Skywest / Alaska	151	164	8.6%	1,407	2,014	43.1%	2,468	19.9%
AMERICAN	201	437	117.4%	2,118	3,021	42.6%	3,614	15.3%
Compass	-	-	0.0%	102	-	-100.0%	-	-100.0%
American/Mesa Air	-	30	100.0%	-	164	100.0%	180	8900.0%
Envoy Air (American)	5	37	640.0%	14	272	1842.9%	272	1713.3%
Republic/ (American)	9	23	155.6%	9	31	244.4%	34	277.8%
SkyWest (American)	103	93	-9.7%	791	1,334	68.6%	1,812	61.6%
DELTA	3,531	4,404	24.7%	27,186	37,382	37.5%	48,525	20.1%
SkyWest (Delta Connection)	2,929	3,566	21.7%	22,925	31,494	37.4%	41,268	27.2%
Compass (Delta Connection)	-	-	0.0%	1	-	-100.0%	-	-100.0%
FRONTIER	92	158	71.7%	748	1,326	77.3%	1,685	45.8%
JETBLUE	43	177	311.6%	1,025	1,279	24.8%	1,483	-14.2%
KLM ROYAL DUTCH AIRLINES	-	-	0.0%	-	-	0.0%	-	-100.0%
SOUTHWEST	447	938	109.8%	5,569	6,913	24.1%	8,338	4.8%
UNITED	56	143	155.4%	901	1,258	39.6%	1,540	27.9%
GoJet	-	-	0.0%	-	-	0.0%	-	-100.0%
Express Jet	-	-	0.0%	10	-	-100.0%	-	-100.0%
Mesa / United Express	-	13	100.0%	98	255	160.2%	257	20.7%
Republic Airways Holdings	-	-	0.0%	32	48	50.0%	60	-69.7%
SkyWest (United Express)	222	494	122.5%	2,250	3,952	75.6%	4,927	39.1%
Trans States	-	-	0.0%	-	-	0.0%	-	0.0%
SUBTOTAL SCHEDULED CARRIERS:	7,819	10,836	38.6%	65,827	91,780	39.4%	117,688	21.3%
CHARTER CARRIERS								
ALLEGiant AIR	-	-	0.0%	-	-	0.0%	-	-100.0%
BOMBARDIER BUSINESS JETS	27	50	85.2%	395	509	28.9%	626	27.8%
BOUTIQUE AIR	-	-	0.0%	-	-	0.0%	-	0.0%
DELTA PRIVATE JETS	-	-	0.0%	-	-	0.0%	-	0.0%
EXECUTIVE JET MANAGEMENT	-	-	0.0%	-	-	0.0%	-	0.0%
FLIGHT OPTIONS	-	-	0.0%	-	-	0.0%	-	0.0%
KALITTA CHARTERS	4	1	-75.0%	47	67	42.6%	86	36.5%
KEYLIME AIR	-	-	0.0%	2	4	100.0%	4	-50.0%
NETJETS	123	158	28.5%	1,108	1,684	52.0%	2,061	41.8%
SUNSET AVIATION	-	-	0.0%	-	-	0.0%	-	0.0%
SWIFT AIR	-	-	0.0%	-	-	0.0%	-	0.0%
VIRGIN AMERICA	-	-	0.0%	-	-	0.0%	-	0.0%
XOJET	26	17	-34.6%	169	131	-22.5%	175	-12.9%
OTHER CHARTER	-	-	0.0%	5	2	-60.0%	2	-66.7%
SUBTOTAL CHARTER CARRIERS:	180	226	25.6%	1,726	2,397	38.9%	2,954	32.9%
CARGO CARRIERS								
AERO CHARTER & TRANSPORT	-	-	0.0%	-	-	0.0%	-	0.0%
AIRNET 11 LLC	-	7	100.0%	-	-	0.0%	39	100.0%
ALPINE AVIATION	175	178	1.7%	1,576	1,602	1.6%	2,082	-2.6%
AMERIFLIGHT	101	89	-11.9%	1,090	913	-16.2%	1,311	-18.9%
CORPORATE AIR (BILLINGS)	-	137	100.0%	1,008	1,244	23.4%	1,664	17.8%
EMPIRE	-	18	100.0%	137	163	19.0%	216	25.6%
FEDERAL EXPRESS	152	141	-7.2%	1,376	1,342	-2.5%	1,884	1.9%
GEM AIR	50	49	-2.0%	472	493	4.4%	735	10.0%
NORTHERN AIR CARGO	-	20	100.0%	-	101	100.0%	101	100.0%
SOUTHERN AIR	-	-	0.0%	137	-	-100.0%	-	-100.0%
UPS	174	141	-19.0%	1,410	1,408	-0.1%	2,046	8.4%
WESTERN AIR EXPRESS	23	29	26.1%	192	216	12.5%	311	54.0%
OTHER CARGO	-	1	100.0%	17	45	164.7%	11	-42.1%
SUBTOTAL CARGO CARRIERS:	675	810	20.0%	7,415	7,527	1.5%	10,400	2.3%
TOTAL LANDINGS	8,674	11,872	36.9%	74,968	101,704	35.7%	131,042	19.8%
TOTAL LANDED WEIGHT								
SCHEDULED CARRIERS								
AEROMEXICO	-	-	0.0%	10,355,000	-	-100.0%	-	-100.0%
ALASKA	-	18,621,188	100.0%	60,052,080	95,556,370	59.1%	105,894,414	17.7%
Horizon Air / Alaska	2,248,710	2,698,452	20.0%	10,344,066	30,582,456	195.7%	39,427,382	142.4%
Skywest / Alaska	11,318,507	12,292,948	8.6%	105,464,499	150,963,398	43.1%	184,993,876	19.9%
AMERICAN	31,058,692	71,025,780	128.7%	313,783,474	491,239,426	56.6%	581,822,254	25.7%
Compass	-	-	0.0%	7,644,900	-	-100.0%	-	-100.0%
Envoy Air (American)	374,750	2,773,150	640.0%	1,049,300	20,386,400	1842.9%	20,386,400	1713.3%
American/Mesa Air	-	2,217,800	100.0%	-	12,135,600	100.0%	13,329,200	8869.9%
Republic (American)	674,550	1,723,850	155.6%	674,550	2,323,450	244.4%	2,548,300	277.8%
SkyWest (American)	6,901,000	6,310,500	-8.6%	52,997,000	89,975,500	69.8%	122,001,500	62.4%
DELTA	537,493,702	710,059,552	32.1%	4,207,050,144	6,140,327,265	46.0%	7,918,577,469	26.7%
SkyWest (Delta Connection)	202,501,917	234,252,346	15.7%	1,533,805,787	2,085,209,571	36.0%	2,750,548,291	27.9%
Compass (Delta Connection)	-	-	0.0%	75,177	-	-100.0%	-	-100.0%
FRONTIER	13,111,536	23,962,604	82.8%	105,950,394	196,106,734	85.1%	247,449,016	48.2%
JETBLUE	6,114,600	25,169,400	311.6%	145,755,000	181,873,800	24.8%	210,882,600	-14.2%

**SALT LAKE CITY INTERNATIONAL AIRPORT
LANDING ACTIVITY
NINE MONTHS ENDED SEPTEMBER 2021**

	September 2020	September 2021	CHANGE	YTD 2020	YTD 2021	CHANGE	12 MO ROLLING Ending 09/2021	% CHANGE
KLM ROYAL DUTCH AIRLINES	-	-	0.0%	-	-	0.0%	-	-100.0%
SOUTHWEST	60,224,000	126,644,800	110.3%	732,928,000	934,704,800	27.5%	1,122,544,800	7.5%
UNITED	7,684,960	20,178,180	162.6%	128,434,760	177,697,260	38.4%	217,473,460	26.7%
GoJet	-	-	0.0%	-	-	0.0%	-	-100.0%
Express Jet	-	-	0.0%	750,000	-	-100.0%	-	-100.0%
Mesa / United Express	-	975,000	100.0%	7,350,000	19,125,000	160.2%	19,275,000	20.7%
Republic Airways Holdings	-	-	0.0%	2,318,986	3,548,361	53.0%	4,426,761	-69.4%
SkyWest (United Express)	16,066,260	34,805,101	116.6%	156,892,168	279,105,754	77.9%	342,588,824	38.9%
Trans States	-	-	0.0%	-	-	0.0%	-	0.0%
SUBTOTAL SCHEDULED CARRIERS:	895,773,184	1,293,710,651	44.4%	7,583,675,285	10,910,861,145	43.9%	13,904,169,547	24.2%
CHARTER CARRIERS								
ALLEGIAN AIR	-	-	0.0%	-	-	0.0%	-	-100.0%
BOMBARDIER	873,503	1,469,743	68.3%	13,355,892	16,812,911	25.9%	20,460,424	22.6%
BOUTIQUE AIR	-	-	0.0%	-	-	0.0%	-	0.0%
DELTA PRIVATE JETS	-	-	0.0%	-	-	0.0%	-	0.0%
EXECUTIVE JET MANAGEMENT	-	-	0.0%	-	-	0.0%	-	0.0%
FLIGHT OPTIONS	-	-	0.0%	-	-	0.0%	-	0.0%
KALITTA CHARTERS	73,220	16,000	-78.1%	893,740	1,251,820	40.1%	2,044,620	50.7%
KEYLIME AIR	-	-	0.0%	63,448	131,526	107.3%	131,526	-48.2%
MIAMI AIR	-	-	0.0%	438,900	-	-100.0%	-	-100.0%
NETJETS	3,623,358	4,880,686	34.7%	33,778,657	52,402,410	55.1%	63,225,993	42.9%
SIERRA PACIFIC	-	-	0.0%	220,000	220,000	0.0%	220,000	0.0%
SUN COUNTRY	-	-	0.0%	-	-	0.0%	-	0.0%
SWIFT AIR	-	-	0.0%	-	-	0.0%	-	0.0%
VIRGIN AMERICA	-	-	0.0%	-	-	0.0%	-	0.0%
XOJET	706,250	642,000	-9.1%	6,222,300	5,135,900	-17.5%	6,768,800	-8.0%
OTHER CHARTER	-	-	0.0%	-	-	0.0%	-	0.0%
SUBTOTAL CHARTER CARRIERS:	5,276,331	7,008,429	32.8%	54,972,937	75,954,567	38.2%	92,851,363	31.1%
CARGO CARRIERS								
ABX AIR INC	-	-	0.0%	-	555,000		555,000	100.0%
AIRNET 11	-	108,500	100.0%	-	606,500	100.0%	606,500	100.0%
ALPINE AVIATION	2,453,500	2,512,200	2.4%	22,050,800	22,292,600	1.1%	29,199,000	-2.5%
AMERIFLIGHT	1,360,500	1,199,700	-11.8%	15,871,950	12,196,682	-23.2%	17,408,682	-25.8%
AMERISTAR	-	27,300	100.0%	299,700	54,600	-81.8%	54,600	-81.8%
ATLAS AIR	-	-	0.0%	3,621,000	544,000	-85.0%	1,904,000	-54.3%
CORPORATE AIR (BILLINGS)	-	1,164,500	100.0%	8,568,000	10,574,000	23.4%	14,144,000	17.8%
EMPIRE	-	825,398	100.0%	4,953,235	6,912,513	39.6%	9,243,422	43.4%
FEDEX EXPRESS	49,808,700	50,623,900	1.6%	457,557,500	458,111,300	0.1%	639,813,900	2.7%
GEM AIR	425,000	416,500	-2.0%	3,973,000	4,174,000	5.1%	6,187,500	10.1%
NORTHERN AIR CARGO	-	2,420,000	100.0%	-	12,221,000	100.0%	12,221,000	100.0%
SOUTHERN AIR INC	-	-	0.0%	16,634,980	-	-100.0%	-	-100.0%
UPS	50,107,200	41,674,160	-16.8%	395,217,560	415,290,580	5.1%	614,170,060	11.7%
WESTERN AIR EXPRESS	299,000	396,500	32.6%	2,496,000	2,856,500	14.4%	4,096,700	56.0%
OTHER CARGO	-	-	0.0%	-	-	0.0%	-	0.0%
SUBTOTAL CARGO CARRIERS:	104,453,900	101,368,658	-3.0%	931,243,725	946,389,275	1.6%	1,349,604,364	5.3%
TOTAL LANDED WEIGHT	1,005,503,415	1,402,087,738	39.4%	8,569,891,947	11,933,204,987	39.2%	15,346,625,274	22.3%

**SALT LAKE CITY INTERNATIONAL AIRPORT
CARGO ACTIVITY REPORT
NINE MONTHS ENDED SEPTEMBER 2021**

	September 2020	September 2021	CHANGE	YTD 2020	YTD 2021	CHANGE	12 MO ROLLING Ending 09/2021	% CHANGE
ENPLANED CARGO								
PASSENGER CARRIERS								
ALASKA	-	7,306	100.00%	77,072	82,143	6.58%	118,323	-14.40%
Horizon Air / Alaska	4,758	2,671	-43.86%	12,232	10,492	-14.22%	16,416	23.50%
Skywest / Alaska	21,184	194	-99.08%	105,311	26,384	-74.95%	47,282	-57.95%
AMERICAN	3,690	5,253	42.36%	94,499	41,512	-56.07%	50,950	-73.58%
American Eagle/Republic	-	140	100.00%	-	140	100.00%	140	100.00%
Compass	-	-	0.00%	120	-	-100.00%	-	-100.00%
Envoy Air (American)	-	-	0.00%	-	50	100.00%	50	100.00%
Mesa	-	4	100.00%	-	293	100.00%	293	100.00%
SkyWest (American)	487	845	73.51%	402,828	10,722	-97.34%	16,890	-95.84%
DELTA	239,502	544,420	127.31%	3,467,124	5,318,218	53.39%	6,307,485	17.87%
KLM ROYAL DUTCH	-	-	0.00%	-	-	0.00%	-	-100.00%
SOUTHWEST	180,455	379,832	110.49%	1,669,064	2,629,493	57.54%	3,248,515	27.98%
UNITED	2,697	5,322	97.33%	44,340	68,113	53.62%	88,070	13.83%
Others	-	-	0.00%	21,579	9,273	-57.03%	44,540	-26.77%
CARGO CARRIERS								
FEDEX EXPRESS*	10,277,351	9,943,137	-3.25%	86,970,535	86,613,539	-0.41%	119,772,319	3.50%
GEM AIR	92,898	50,910	-45.20%	683,780	585,115	-14.43%	874,897	1.89%
SOUTHERN AIR	-	-	0.00%	251,000	-	-100.00%	-	-100.00%
UPS	6,216,512	4,723,445	-24.02%	48,197,495	48,398,894	0.42%	70,101,566	5.96%
MISC CARGO	729,380	971,264	33.16%	8,716,782	9,921,660	13.82%	13,063,630	10.68%
ABX AIR	-	-	0.00%	-	50,557	100.00%	50,557	100.00%
TOTAL ENPLANED CARGO	17,768,914	16,634,743	-6.38%	150,713,761	153,716,041	1.99%	213,751,366	4.85%
DEPLANED CARGO								
PASSENGER CARRIERS								
ALASKA	-	32,666	100.00%	40,808	117,934	189.00%	141,363	71.57%
Horizon Air / Alaska	4,943	1,848	-62.61%	19,855	14,384	-27.55%	20,824	-16.02%
Skywest / Alaska	21,665	3,560	-83.57%	83,146	69,954	-15.87%	81,694	-19.57%
AMERICAN	24,770	22,561	-8.92%	197,990	259,744	31.19%	341,566	30.68%
American Eagle/Republic	-	7	100.00%	-	7	100.00%	7	100.00%
Compass	-	-	0.00%	187	-	-100.00%	-	-100.00%
Envoy	-	-	0.00%	-	1,361	100.00%	1,361	100.00%
Mesa (American)	-	-	0.00%	-	378	100.00%	378	100.00%
SkyWest (American)	1,833	812	-55.70%	7,253	8,845	21.95%	14,647	66.67%
DELTA	360,403	1,088,440	202.01%	4,726,508	7,517,018	59.04%	8,838,364	20.37%
KLM ROYAL DUTCH	-	-	0.00%	-	-	0.00%	-	-100.00%
SOUTHWEST	304,650	440,245	44.51%	2,392,709	3,556,309	48.63%	4,548,733	25.81%
UNITED	10,576	34,234	223.70%	97,940	226,001	130.75%	278,356	33.30%
Others	5,406	874	-83.83%	105,422	48,677	-53.83%	186,075	2.64%
CARGO CARRIERS								
FEDEX EXPRESS*	8,860,114	9,164,230	3.43%	74,902,506	77,293,656	3.19%	105,935,481	5.34%
GEM AIR	25,071	21,043	-16.07%	195,747	200,767	2.56%	266,150	13.33%
SOUTHERN AIR	-	-	0.00%	1,688,688	-	-100.00%	-	-100.00%
UPS	8,072,195	5,777,869	-28.42%	63,610,536	53,648,461	-15.66%	78,318,211	-10.34%
MISC CARGO	186,297	412,162	121.24%	3,547,836	4,621,683	30.27%	6,283,603	28.86%
ABX AIR	-	-	0.00%	-	108,180	100.00%	108,180	100.00%
TOTAL DEPLANED CARGO	17,877,923	17,000,551	-4.91%	151,617,131	147,585,179	-2.66%	205,256,813	-1.04%
TOTAL CARGO	35,646,837	33,635,294	-5.64%	302,330,892	301,301,220	-0.34%	419,008,179	1.88%

*FEDEX EXPRESS includes mail



Salt Lake City
Department of Airports

COMPARISON OF ON TIME OPERATIONS
August 2021

ARRIVALS

Airport	Flights	% On Time	Rank
HNL HONOLULU	5,001	87.0	1
ATL HARTSFIELD-JACKSON ATLANTA INTL	28,137	84.1	2
MSP MINNEAPOLIS-ST. PAUL INTL	11,660	82.8	3
SLC SALT LAKE CITY INTL	11,437	82.1	4
SEA SEATTLE-TACOMA INTL	16,751	81.5	5
DTW DETROIT METRO WAYNE CNTY	12,131	81.2	6
CLT CHARLOTTE DOUGLAS	20,563	79.5	7
SFO SAN FRANCISCO INTL	9,753	79.2	8
LAX LOS ANGELES INTL	17,814	78.8	9
LGA NEW YORK LAGUARDIA	7,707	77.9	10
DCA RONALD REAGAN NATIONAL	7,948	77.4	11
PDX PORTLAND INTL	5,572	77.3	12
SAN SAN DIEGO LINDBERGH FIELD	6,545	77.3	13
PHX PHOENIX SKY HARBOR INTL	14,479	76.4	14
BOS BOSTON LOGAN INTL	9,156	76.2	15
PHL PHILADELPHIA INTL	10,802	75.3	16
JFK NEW YORK JFK INTL	8,105	74.3	17
IAH HOUSTON GEORGE BUSH	15,266	73.3	18
LAS LAS VEGAS MCCARRAN INTL	13,732	73.3	19
MIA MIAMI INTL	7,902	71.9	20
DEN DENVER INTL	26,756	71.8	21
DFW DALLAS-FT. WORTH REGIONAL	26,195	71.7	22
ORD CHICAGO O HARE	30,913	70.6	23
IAD WASHINGTON DULLES	7,727	70.4	24
MDW CHICAGO MIDWAY	6,580	70.0	25
TPA TAMPA INTL	5,801	69.4	26
BWI BALTIMORE/WASHINGTON INTL	7,188	68.5	27
FLL FT. LAUDERDALE	7,818	65.9	28
EWR NEWARK LIBERTY INTERNATIONAL	9,411	65.7	29
MCO ORLANDO INTL	12,205	65.5	30
AVERAGES	12,702	75.2	

DEPARTURES

Airport	Flights	% On Time	Rank
HNL HONOLULU	5,001	89.4	1
SFO SAN FRANCISCO INTL	9,751	83.3	2
MSP MINNEAPOLIS-ST. PAUL INTL	11,649	83.1	3
DTW DETROIT METRO WAYNE CNTY	12,034	82.8	4
SLC SALT LAKE CITY INTL	11,434	82.5	5
ATL HARTSFIELD-JACKSON ATLANTA INTL	28,121	80.5	6
SEA SEATTLE-TACOMA INTL	16,749	80.5	7
BOS BOSTON LOGAN INTERNATIONAL	9,061	80.3	8
PDX PORTLAND INTERNATIONAL	5,572	80.3	9
SAN SAN DIEGO LINDBERGH FIELD	6,542	79.5	10
LGA NEW YORK LAGUARDIA	7,669	78.8	11
DCA RONALD REAGAN NATIONAL	7,869	78.7	12
LAX LOS ANGELES INTL	17,816	76.9	13
PHL PHILADELPHIA INTL	8,809	76.7	14
CLT CHARLOTTE DOUGLAS	18,538	76.5	15
TPA TAMPA INTERNATIONAL	5,802	73.3	16
IAH HOUSTON GEORGE BUSH	12,982	72.9	17
JFK NEW YORK JFK INTL	8,103	72.6	18
PHX PHOENIX SKY HARBOR INTL	14,481	72.3	19
IAD WASHINGTON DULLES	5,202	71.6	20
MIA MIAMI INTL	7,899	71.0	21
ORD CHICAGO O HARE	25,679	69.7	22
LAS LAS VEGAS MCCARRAN INTL	13,723	67.8	23
DFW DALLAS-FT. WORTH REGIONAL	26,208	67.5	24
DEN DENVER INTERNATIONAL	25,830	66.9	25
EWR NEWARK LIBERTY INTERNATIONAL	8,490	65.2	26
FLL FT. LAUDERDALE	7,814	64.9	27
MCO ORLANDO INTL	12,204	64.9	28
BWI BALTIMORE/WASHINGTON INTL	7,184	54.0	29
MDW CHICAGO MIDWAY	6,583	51.6	30
AVERAGES	12,160	73.9	

ON TIME ARRIVAL PERFORMANCE AT SLC

By Carrier

Air Carrier	Flights	% On Time
DL DELTA	8,304	87.9%
F9 FRONTIER	184	73.9%
UA UNITED	713	70.1%
AS ALASKA	368	69.8%
AA AMERICAN	669	67.3%
B6 JETBLUE	186	66.7%
WN SOUTHWEST	1,013	61.3%
AVERAGES	9,416	91.9%

Source: DOT Air Travel Consumer Report

DESIGN AND CONSTRUCTION REPORT

TABLE OF CONTENTS

- I. Area Map of Project Locations
- II. Project Schedule
- III. Construction Analysis
- IV. Design and Construction Report



Salt Lake City
International Airport

2021 - 2022 Project Legend

Airfield

1. Airfield Lighting Wiring Phase 5
2. T/W G Centerline PCC Panel Replacement
3. North Cargo Apron Site Development

Landside

4. QTA Deck Coating
5. Glycol Plant & Wildlife Services Office Bldg.
6. Electric Vehicle Charging Stations
7. Economy Parking Lot Bus Route Reconfiguration
8. GA Zone 3 Corporate Hangar Site Development



SALT LAKE CITY INTERNATIONAL AIRPORT
CONSTRUCTION PROGRAM
2021/2022 Construction Schedule

ID	Task Name	Start	Finish	Jun '21	Jul '21	Aug '21	Sep '21	Oct '21	Nov '21	Dec '21	Jan '22
1	Project Title	Sun 6/16/19	Fri 9/16/22								
2	(1) Airfield Lighting Wiring Phase 5	Tue 4/27/21	Fri 11/5/21								
3	(2) T/W G Centerline PCC Panel Replacement	Mon 5/24/21	Mon 11/1/21								
4	(3) North Cargo Apron Site Development	Mon 8/23/21	Fri 9/16/22								
5	(4) Quick Turn Around (QTA) Deck Coating	Thu 10/1/20	Wed 11/3/21								
6	(5) Glycol Plant & Wildlife Services Office Bldg.	Thu 9/17/20	Thu 10/14/21								
7	(6) Electric Vehicle Charging Stations	Sun 6/16/19	Wed 11/10/21								
8	(7) Economy Parking Lot Bus Route Reconfiguraion	Mon 5/17/21	Tue 9/28/21								
9	(8) GA Zone 3 Corportate Hangar Site Development	Wed 12/1/21	Fri 5/13/22								

Project: Microsoft Project (latest)
Date: Mon 11/8/21

DESIGN		Inactive Milestone		Manual Summary	
CONSTRUCTION		Inactive Summary		Start-only	
SCOPING		Manual Task		Finish-only	
SUMMARY		Duration-only		Deadline	
Inactive Task		Manual Summary Rollup			

SALT LAKE CITY DEPARTMENT OF AIRPORTS
CONSTRUCTION PROJECT STATUS 2021 - 2022

#	PROJECT NAME	ENGINEER'S ESTIMATE	BID AMOUNT	APPROVED CHANGE ORDERS TO DATE	% OF COST INCREASE TO DATE	STATUS	CONTRACTOR
CONSTRUCTION							
1	Airfield Lighting Wiring Phase 5	\$ 2,875,245	\$ 2,649,958			complete	Cache Valley Electric
2	Taxiway G Centerline PCC Panel Replacement	\$ 2,235,325	\$ 2,347,930	\$ 40,218	1.71%	on schedule	Ames Construction
3	North Cargo Apron Site Development	\$ 25,763,000	\$ 22,141,148	\$ (15,000)	-0.07%	on schedule	Ames Construction
4	Quick Turn Around (QTA) Deck Coating	\$ 1,500,000	\$ 1,080,628	\$ 339,612	31.43%	complete	Paulsen Construction
5	Glycol Plant & Wildlife Services Office Bldg.	\$ 3,106,683	\$ 3,335,000	\$ 135,019	4.05%	complete	Cal Wadsworth Construction
6	Electric Vehicle Charging Stations	\$ 291,764	\$ 360,000			on schedule	Saunders Construction
7	Economy Parking Lot Bus Route Reconfiguration	\$ 1,824,590	\$ 1,775,112	\$ (250,764)	-14.13%	on schedule	Cal Wadsworth Construction
8	GA Zone 3 Corporate Hangar Site Development	\$ 1,213,237	\$ 1,169,378			award process	Ames Construction
	Total	\$ 38,809,844	\$ 34,859,154	\$ 249,085	0.71%		
Budget amount, Engineer's estimate, and Bid amount is based on construction cost only.							

CONSTRUCTION REPORT

CONSTRUCTION

- (1) **Airfield Lighting Wiring Phase 5** - Substantial completion for this project was issued on November 5, 2021. The Contractor is currently working on punch list items.
- (2) **Taxiway G Centerline PCC Panel Replacement** - A preliminary walk through for this project took place on November 1, 2021. It is anticipated the Contractor will be issued substantial completion by November 12, 2021 and will begin working on punch list items as weather permits.
- (3) **North Cargo Apron Site Development** - The Contractor continues to submit product submittals to be reviewed and approved by SLCDA. Temporary fencing has been placed. Earthwork operations continue to clear and excavate the project site. Utility work has also started this week.
- (4) **Quick Turn Around (QTA) Deck Coating** - Substantial completion for this project was issued on November 3, 2021. The Contractor is currently working on punch list items.
- (5) **Glycol Plant and Wildlife Services Office Building** - Substantial completion for this project was issued on October 14, 2021. The Contractor is currently working on punch list items.
- (6) **Electric Vehicle Charging Stations** - This project is nearing completion with a final walkthrough scheduled for November 15, 2021.
- (7) **Economy Parking Lot Bus Route Reconfiguration** - Construction of the new concrete east/west bus lanes in Phases 1 - 3 has been completed and opened for use. Demolition and asphalt patching of the former eight bus stops is currently taking place.
- (8) **GA Zone 3 Corporate Hangar Site Development** - This project will provide site development within General Aviation Zone 3 on the east side of the Salt Lake City International Airport (SLCIA) to support future corporate hangar expansion. Work will include demolition of an existing row of T-hangars and site preparation consisting of taxilane pavement reconstruction and new underground utility installation for gas, power, communication, water, storm drain, and sewer within 5 feet of the future hangar lease line. The new taxilane pavement will be constructed up to the future hangar lease line for access. The bid opening for this project was held on October 28, 2021. The apparent low bidder is Ames Construction. Contract documents are currently being prepared.



Advisory Board
Meeting

November 17, 2021

Media Clippings

<https://slcairport.com/assets/pdfDocuments/AABoard/Nov2021boardclippings.pdf>

Compiled by the Communication & Marketing Dept.